

International Congress
of Mathematicians
in Rio de Janeiro

ICM 2014

Contents

Presentation.....	
Letters of Support	
General Information	
Mathematics in Brazil	
Scientific Events in Rio	
Convention Centers	
Transportation	
Satellite Activities	
General Assembly	
Tourism and Culture	



Presentation



To the Members of the International Mathematical Union

Dear Colleagues,

As the President of the Sociedade Brasileira de Matemática, and on behalf of the whole Brazilian mathematical community, I would like to propose Brazil to host the International Congress of Mathematics of 2014. As you know, this would be the first time this prestigious event would take place in Latin America.

Brazil became a member of the International Mathematical Union in 1954. Since then, mathematical research in this country has developed in a fast and steady way. Not only have the number of researchers and the production of papers increased, but also publications have become better and more diverse.

Each year we have been seeing an increase in the number of young people choosing the mathematical researcher career, which has contributed to the renovation of the area and the vitalization of the ambient of our research institutions. In addition, Brazil has also been having a fundamental role in helping disseminate mathematical activities across Latin America.

Needless to say, a lot remains to be done in order to fulfill the entire potential of a country of continental dimensions such as ours, and bring mathematical research to each one of its regions. The ICM 2014 in Brazil will greatly add to the momentum of Mathematics in our country, and will certainly be a landmark in the history of Mathematics in Latin America, with great impact on all national mathematical communities of the region.

I deeply hope to meet all of you in Rio de Janeiro in 2014.

João Lucas Barbosa

João Lucas Marques Barbosa
Presidente da Sociedade Brasileira de Matemática

Why have the ICM in Rio?

The realization of the ICM in Rio de Janeiro in 2014 could not come at a better time, as Brazilian Mathematics stands on a threshold. Following decades of development and increasing international recognition, a new wave of growth must now take place, to meet the needs of a country of continental proportions.

Brazilian research in Mathematics has greatly evolved from its humble beginnings in the Fifties. In 1951 the National Research Council (CNPq) was founded. One of CNPq's first initiatives was the creation of the Instituto de Matemática Pura e Aplicada (IMPA) in Rio de Janeiro, one year later. Brazil joined the International Mathematical Union in 1954, as a Group I member. Back then, the mathematical community consisted of a few courageous pioneers, most of whom attended the first Brazilian Mathematical Colloquium in 1957.



Group Photo of the 1st Brazilian Mathematical Colloquium

In the ensuing half century, the mathematical landscape has changed dramatically. The country now boasts a vibrant mathematical community with quite impressive achievements. There are 45 graduate programs in Mathematics and Statistics, granting about 120 doctoral degrees a year in Mathematics and Statistics. The national community is estimated at 1,000 active researchers. The latest edition of the Brazilian Mathematical Colloquium gathered over 1,200 researchers and students, graduate and undergraduate, celebrating 50 years of uninterrupted activities.

The presence of Brazilian mathematicians in the international scenario has increased accordingly. Eleven invited or plenary lectures have been given at ICMs by mathematicians working in Brazil. A good number of Brazilians have served in the various other bodies of the IMU. Ever since it joined in as a member, Brazil has been collaborating actively in all major activities of the Union. The country has continuously ascended in the IMU group system, culminating with the promotion to Group IV in 2005.

The ICM 2014 in Rio de Janeiro will greatly contribute to the social and political visibility of Mathematics, fueling further development in the country. As the Brazilian economy grows increasingly solid, support to research has been rising substantially, and the national authorities are signaling their wish to enhance Brazil's presence in all major international stages. The Brazilian mathematical community has matured, and is more than ready for the challenge of staging an event of this magnitude.

The ICM 2014 in Rio de Janeiro is also bound to have a strong impact in the whole of Latin America, with the realization of several satellite activities across the region. Brazil has greatly contributed to the development of Mathematics in Latin America, by training mathematicians and promoting collaborations between a great number of Latin American researchers. Many of the best active researchers throughout the region have been trained in Brazilian institutions, and various forms of scientific partnership have been developed between Brazilian mathematicians and institutions and their Latin American counterparts.

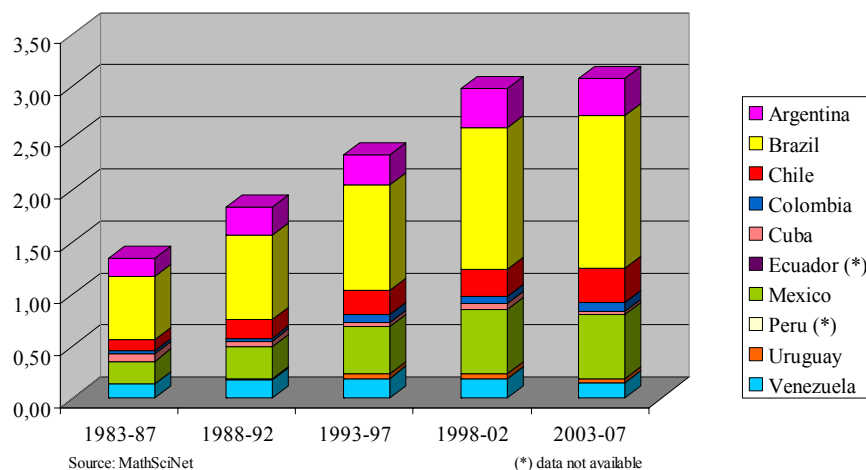

Papers by Mathematicians in Latin America (% of World)

Brazil also plays a crucial role in the activities of the Mathematical Union for Latin America and the Caribbean (UMALCA) ever since it was created in 1995, decisively supporting its efforts to promote the development of Mathematics in the continent. Indeed, UMALCA is associated to this bid by proposing to organize a string of satellite Schools of Mathematics in some least developed regions of Latin America, with ICM speakers as course lecturers.

"Active collaboration between mathematicians of the Latin American area and Brazilian scientists and institutions is an important ingredient in the steady development of mathematics in several of the countries of the region."

José Antonio de la Peña, President of UMALCA

"Brazil, moreover, has been a center that catalyses relations between other countries in Latin America. Many Mexican-Uruguayan and Mexican-Peruvian relations cannot be understood without the central role of Brazil"

Oscar Sánchez, Director of CIMAT, Mexico

Latin America now counts 10 countries as members of the IMU and has never hosted an International Congress of Mathematicians. On the other hand, the ICM has been previously held 19 times in Europe (in 12 different countries), 4 times in North America (twice in Canada and twice in the USA), and 3 times in Asia (Japan, China, and India).

The *Wonderful City* hosts several international events in science, business, and sports, every year. It looks forward to welcoming the world mathematical community in 2014!



Letters of Support



Minister of Science and Technology
State Governor of Rio de Janeiro
State Secretary of Science and Technology
Research Agency of the State of Rio de Janeiro (FAPERJ)
City Mayor of Rio de Janeiro
Secretary of Tourism
Secretary of Tourism, Sport and Leisure
Brazilian Tourist Board (EMBRATUR)
Rio Convention & Visitors Bureau

Associação Brasileira de Estatística (ABE)
Sociedade Brasileira de Educação Matemática (SBEM)
Sociedade Brasileira de História da Matemática (SBHMAT)
Sociedade Brasileira de Matemática Aplicada e Computacional (SBMAC)

Universidade Federal do Ceará (UFC)
Universidade de Brasília (UNB)
Universidade Federal de Minas Gerais (UFMG)
Instituto Nacional de Matemática Pura e Aplicada (IMPA)
Universidade Federal de Pernambuco (UFPE)
Pontifícia Universidade Católica do Rio de Janeiro (PUC-Rio)
Universidade do Estado do Rio de Janeiro (UERJ)
Universidade Federal do Rio de Janeiro (UFRJ)
Universidade Federal Fluminense (UFF)
Universidade Federal do Rio Grande do Sul (UFRGS)
Universidade Federal de São Carlos (UFSCAR)
Universidade Estadual Paulista (UNESP)
Universidade de São Paulo (USP)

Portugal

Sociedade Portuguesa de Matemática

Argentina

Unión Matemática Argentina
Instituto Argentino de Matemática, CONICET, Buenos Aires
Departamento de Matemática, Universidad de Buenos Aires
Centro de Investigación y Estudios de Matemática de Córdoba
Facultad de Matemática Astronomía y Física, Universidad de Córdoba

Chile

Academia Chilena de Ciencias
Pontificia Universidad Católica de Chile
Pontificia Universidad Católica de Valparaíso

Colombia

Sociedad Colombiana de Matemáticas

Mexico

Centro de Investigación en Matemáticas (CIMAT), Guanajuato
Instituto de Matemáticas de la UNAM, Cuernavaca
Instituto de Matemáticas de la UNAM, Mexico City

Paraguay

Sociedad Científica del Paraguay

Peru

Sociedad Matemática Peruana

Uruguay

Sociedad Uruguaya de Matemática y Estadística

Venezuela

Asociación Matemática Venezolana

UMALCA - Mathematical Union for Latin America and the Caribbean



Ofício nº 830 /MCT

31.10.2008

Mr.
Prof LÁSZLÓ LOVÁSZ
President of the International Mathematical Union

Subject: **International Congress of Mathematicians**

Dear Prof Lovász,

In my capacity as Minister of Science and Technology of Brazil, I want to express the full support of the Brazilian government to the initiative to host the International Congress of Mathematicians 2014 in Rio de Janeiro.

2. As an active researcher in Physics, and former vice-president of the International Union for Pure and Applied Physics, I am aware of the strong presence and contribution of Brazilian Mathematicians to IMU through the years, as well as to the frontiers of mathematical research.

3. It is to be noted that Brazil joined the IMU as far back as 1954. Thus, I believe time has come for Brazil to host the main and most prestigious mathematical meeting, for the first time in Latin America, and I assure of full backing from the Brazilian authorities.

Best regards,

SERGIO MACHADO REZENDE
Minister of Science and Technology

Esplanada dos Ministérios - Bloco E - Sala 400 - 70.067-900 - Brasília - DF
Fone: (0xx61) 3317-7925 / 3317-7444 - Fax: (0xx61) 3317-7769 - ministro@mct.gov.br





GOVERNO DO ESTADO DO RIO DE JANEIRO
GOVERNADOR

Rio de Janeiro, October 10, 2008

Dear Prof László Lovász
President of the International Mathematical Union

Dear Prof Lovász,

In my capacity as State Governor of Rio de Janeiro I would like to express the full support of the State authorities to the Brazilian bid to organize the International Congress of Mathematicians 2014 in our capital city.

Rio de Janeiro, famous for its breathtaking scenery and the warmth of its people, is today much more than a leisure destination for tourists. Guided by strategic planning that is bringing major investment to the sector, tourism linked to business, sport, and science is enjoying significant growth all around the State.

Rio de Janeiro is proud of the scientific institutions hosted in the State, many of which reach international standards of excellence. The State Government has been enhancing substantially its financial support to Science, most notably through the State Secretary for Science and Technology and the State Research Agency FAPERJ.

For these and many other regions, I am happy to say that the Wonderful City, like Christ the Redeemer, welcomes the world mathematical community with open arms.

Best regards,

Sérgio Cabral

Governador do Estado do Rio de Janeiro





GOVERNO DO ESTADO DO RIO DE JANEIRO
SECRETARIA DE ESTADO DE CIÊNCIA E TECNOLOGIA

OF. SECT/GAB Nº 419

Rio de Janeiro, 10 de outubro de 2008.

Prof László Lovász
President of the International Mathematical Union

Dear Mr. Lovász,

We very happy to learn that Brazilian mathematical institutions are bidding to organize the 2014 edition of the International Congress of Mathematicians in our city of Rio de Janeiro. This initiative has my full support, as Secretary for Science and Technology of the State of Rio de Janeiro.

We are well aware of the prestige of the International Congress of Mathematicians and the mathematical Prizes awarded by the IMU on that occasion, as we are also well informed of the contribution Brazilian mathematicians have been giving to the IMU and the cause of Mathematics around the world.

We are certain the mathematical community in our State is ready for the challenge of organizing such a meeting and, needless to say, the hospitable city of Rio de Janeiro offers excellent conditions for the realization of major scientific events.

The State of Rio de Janeiro is home to several scientific and technological institutions of excellence, in particular, in the field of Mathematics. The State authorities are committed to consolidating and expanding this fundamental asset and to ever increasing support to Science in the State.

For all these reasons, I am happy to assure you that the realization of the ICM2014 in Rio de Janeiro will have the strongest support of the State administration.

Best regards,

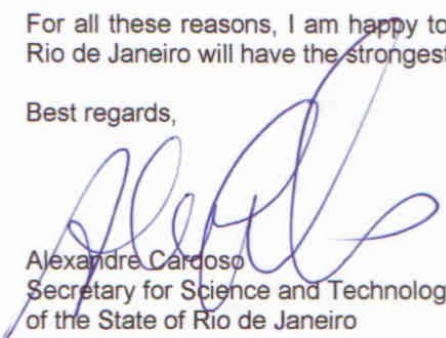
Alexandre Cardoso
Secretary for Science and Technology
of the State of Rio de Janeiro

Rua da Ajuda, 5 10º andar - Centro
CEP 20040-000 - Rio de Janeiro - RJ



SECRETARIA DE
CIÊNCIA E TECNOLOGIA

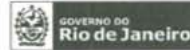

SECRETARIA DE
CIÊNCIA E TECNOLOGIA

Prof László Lovász
President of the International Mathematical Union

Dear professor Lovász,

As Directors of FAPERJ, the state research agency of Rio de Janeiro, we want to express the full support of our scientific community to the organization of the International Congress of Mathematicians ICM 2014 in our state capital.

The state of Rio de Janeiro hosts a large number of institutions devoted to research, development and innovation, in a wide variety of areas of Science and Technology, including a majority of Brazil's centers of excellence. FAPERJ aims to consolidate and expand this precious patrimony and further enhance the role of Rio de Janeiro and its scientists in the international stage.

We are especially proud of the development that Mathematics has attained in our state, and in Brazil as a whole. Our mathematical community is certainly ready for the challenge of organizing an event such as the ICM. On behalf of FAPERJ, we commit its strongest support to helping make Rio de Janeiro the world capital of Mathematics.

Very best regards,

Ruy Garcia Marques
Director-President

Jerson Lima Silva
Scientific Director

Av. Erasmo Braga nº 118/6º andar
Castelo - Rio de Janeiro/RJ
CEP: 20020-000

Tel.: 3231-2929
Fax: 2533-4453 / 2533-8687
www.faperj.br



Rio de Janeiro, September 15th, 2008.

To the
International Mathematical Union - IMU
C/O: Prof. László Lovász / President

Re: International Congress of Mathematicians – ICM 2014

Dear Sirs,

It is with great pleasure that the City of Rio de Janeiro extends its official invitation to the International Congress of Mathematicians in 2014.

We look forward to being able to give you and your members a warm welcome in 2014 and to making sure you receive the genuine "carioca" hospitality.

Rio is definitely a professional choice to host important international events such as yours, since it provides excellent meeting and recreation facilities plus a very efficient and comfortable accommodations network.

The natural beauty of our city with its famous white sandy beaches, rain forest and breathtaking views from the mountain tops which surround it, turns it into the ideal gift for leisure tourism, business and incentive travel, congresses, conventions and exhibitions.

In addition, the population of Rio is naturally friendly and warmhearted, and our cultural traditions, cuisine and nightlife are not only good but special.

Our city is suited to all tastes, offering something to everyone, allowing them to become acquainted with the many sides and charms of Rio de Janeiro.

Speaking from experience, I feel sure that you could not choose a better venue for your event.

I look forward to meeting you in 2014.

Welcome to Rio !

Cesar Maia
Mayor
City of Rio de Janeiro

Rua Afonso Cavalcanti, n.º 455 – 13.º andar - sl. 1329
Cidade Nova - Rio de Janeiro/RJ - Brasil – CEP.: 20.211-110
☎ 2503-2812 / ☎ 2503-2815 – www.rio.rj.gov.br



PREFEITURA

TURISMO

Carta nº 085/2008/SETUR

Rio de Janeiro, September 24th, 2008.

To the
International Mathematical Union - IMU
C/O: Prof. László Lovász / President

Re: International Congress of Mathematicians – ICM 2014

Dear Sirs,

The unique setting of Rio de Janeiro makes it different from other megacities in the world. Here, the city unveils itself in all contrasts from the ocean beaches to the rain forest. An endless sequence of varied shaped hills and the huge mass of ocean waters design its coastline.

Centred mostly around the downtown area, Rio de Janeiro's historical attractions and cultural tradition reveal unexpected treasures from the past, side by side, with contemporary notable buildings hosting a modern lifestyle. Rio has been the political and cultural center of Brazil since the 18th century.

Cariocas, as the natives and residents of Rio are called, are a naturally happy, friendly and receptive people, always willing to share the carioca spirit with all visitors.

An ideal city for international congresses, conventions and exhibitions, Rio de Janeiro can host a great number of participants in any type of event. There are two modern and well equipped convention centers in the city. There are also hotels and conference services suited to all budgets, and to all leisure or business requirements. The hotels' substructure is being constantly inspected, ensuring that services and technology are continuously improved.

We will be much honored if the City of Rio de Janeiro is selected to host the International Congress of Mathematicians in 2014.

Welcome to Rio!

RUBEM MEDINA
Secretary of Tourism
City of Rio de Janeiro



SECRETARIA DE
TURISMO, ESPORTE E LAZER



CT/GAB/Nº024/08

Rio de Janeiro, September 1st, 2008.

To the
International Mathematical Union - IMU
C/O: Prof. László Lovász / President

Re: International Congress of Mathematicians – ICM 2014

Dear Sirs,

The State of Rio de Janeiro Tourism Authority has the pleasure to offer all the support within its capability to host the International Congress of Mathematicians in Rio de Janeiro, in 2014.

The City of Rio is considered one of the world's dream cities - It is located in a beautiful natural environment which brings dramatically together the mountains and the sea in a luxuriant tropical setting, all this highlighted by one characteristic that is fundamental: the friendliness of its people.

Rio also offers a wide range of options for tourism and business: Qualified infra-structure, accommodations, eating out, entertainment, sports, transport, excellent group services and a modern Convention Center - Riocentro.

Rio should not be looked as a single destination but as a Gateway to Brazil. Some of the many wonders of the country can be found within a two hour drive of the city, in the State of Rio de Janeiro.

A variety of options that can take visitors to the mountains, the beaches, the Atlantic forest, historic towns or fishing villages, depending only on the visitors choice.

Our professional team will be willing to provide information, promotional material and other kind of support you may need for the accomplishment of this event in Rio de Janeiro.

Looking forward to welcome you to Rio in 2014, we remain.

Sincerely Yours,

Marcia Lins
Secretary

Rua México nº 125 – 8º andar. CEP: 20.031-145. FAX: 2299.3052
TEL : 2299.3100 / 2299.3070
Disque Turismo: 0800.282.2007



PRESIDENT OFFICIAL LETTER



OF. PRESI Nº 153/2008

Brasília, September 2nd, 2008

To the
International Mathematical Union - IMU
C/O: Prof. László Lovász / President

Dear Sirs,

The Brazilian Tourist Board - EMBRATUR - institutionally supports the holding of international meetings in our country. We are prepared to make all the necessary arrangements for the quality accomplishment of such important events.

Therefore, it was with great pleasure that we learned about the strong possibility of the **International Congress of Mathematicians - ICM** being held in Brazil in 2014. We are sure that Brazil is the only destination where one can find and combine the excellence of forestry, nature, the environment, a peaceful cultural mix and other subjects of interest.

If you decide upon Brazil to host your event, you can rely on our official support to guarantee excellent services for your delegates. With consideration to entry formalities for foreign citizens, visas are only required for participants from countries adopting the same policy for Brazilian citizens.

In this case, we interface with the Ministry of Foreign Affairs to help facilitate visas for the participants.

We look forward to seeing you in 2014.

Yours Sincerely,

A handwritten signature in black ink that reads 'Jeanine Pires'.

Jeanine Pires
President

EMBRATUR – Brazilian Tourism Board
SCN, Qd. 2, Bloco G - Brasília/DF - 70712-907 - Brasil
Tel.: (55 61) 3429-7923 / Fax: (55 61) 3429-7900

congressos@embratur.gov.br / www.embratur.gov.br

Ministry
of Tourism



Rio de Janeiro, September 1st, 2008.

To the
International Mathematical Union - IMU
C/O: Prof. László Lovász / President

Re: International Congress of Mathematicians – ICM 2014

Dear Sirs,

The Rio Convention & Visitors Bureau was thrilled and honored to learn that you are considering Rio de Janeiro as the host for the International Congress of Mathematicians in 2014.

The cosmopolitan city of Rio is ideal for international meetings. Home to more than 6 million inhabitants, Rio boasts fantastic weather, savory cuisine, hospitable people, sport, entertainment and quality meeting facilities and a modern infrastructure to ensure that your event runs smoothly. With more than 23,000 hotel rooms and ample meeting spaces, including Riocentro – the largest convention center in Latin America – Rio is a logical choice for your conference.

Rio de Janeiro has also created a Joint Committee of Tourist Security. The committee is composed of military and civil police forces, fire department, municipal and state tourist offices, the Rio Convention & Visitors Bureau, the Brazilian Association of Travel Agents, the Brazilian Association of Professional Congress Organizer Companies, among others. This joint committee can be summoned to provide special security for congresses, events and groups in the city.

In addition, for some years now, Rio de Janeiro has been awarded the 1st position for international meetings on the North, Central and South American Continent by the ICCA - International Congress & Convention Association's statistics

Please count on our institutional support and do not hesitate to contact us with any questions or concerns surrounding the event. On behalf of the Rio Convention & Visitors Bureau we welcome you to Rio.

Kind Regards,



Paulo Senise
Executive Director

Rua Guilhermina Guinle, 272 / 6 andar
22270-060 Rio de Janeiro – RJ
Tel: (21) 2539-2942 Fax: (21) 2286-7272
Email: rcb@rcvb.com.br
www.rioconventionbureau.com.br



São Paulo, August 28, 2008.

To: Professor Dr. Lászlo Lovász
President
International Mathematical Union (IMU)

Dear Professor Lovász,

The **Brazilian Statistical Society** (Associação Brasileira de Estatística – ABE) is proud to be associated with the Brazilian candidacy to host the International Congress of Mathematicians ICM 2014.

The Brazilian Statistical Society congregates all the statisticians of our country. The members of our society are from the academia, from government and research agencies, and also from the private sector. This society organizes and supports all scientific events in Brazil in the area of Statistics.

We are certain that the realization of the ICM in Rio de Janeiro will be a pivotal moment in the history of Mathematics in our country that will command great enthusiasm from our students, professors and professionals.

We commit our full support to this initiative and hope it will receive a most positive reception from IMU.

Best regards,

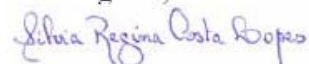

Silvia Regina Costa Lopes
President of the **Brazilian Statistical Society**

Rua do Matão, 1010 – Caixa Postal 66281 – São Paulo-SP - CEP: 05311-970 – Tel: 3091 6261 – Fax: 3812-5067



Sociedade Brasileira de Educação Matemática

Departamento de Matemática – UFPE

Sala 108 - Avenida Professor Luiz Freire S/N – Cidade Universitária –

Recife - CEP: 50.740-540

Home page: www.sbem.com.br

e-mail: sbem@sbem.com.br

Tel./Fax (81) 3272-7563

Recife, September 15, 2008

To:

Prof. László Lovász

President of the International Mathematical Union

It is with great satisfaction that the Board of Directors of the Sociedade Brasileira de Educação Matemática (SBEM) manifests the support to the candidacy of the Sociedade Brasileira de Matemática (SBM) to host the International Congress of Mathematicians in Rio de Janeiro in 2014.

Undeniably, the International Congress of Mathematicians to be held in Brazil will bring positive contributions to the scientific development of our country and of Latin America as well.

Furthermore, we certainly expect the Congress to promote awareness on mathematics education issues, which is a matter of increasingly importance in our societies in recent times.

We look forward to the success of this candidacy and send our

Best regards.

A handwritten signature in blue ink that reads "Paulo Figueiredo Lima".

Paulo Figueiredo Lima
President – SBEM

Sociedade Brasileira de
História da Matemática
CNPJ: 04.288.344/0001-07



SBHMat

Fundada em
30.03.1999

László Lovász
President of the
International Mathematical Union – IMU

Rio Claro, September 12, 2008

Dear Prof. László Lovász

On behalf of the Brazilian Society for the History of Mathematics (SBHMat), I am writing in support of the Brazilian Society of Mathematics' (SBM) candidacy to host, in Rio de Janeiro, the International Congress of Mathematicians in 2014. SBHMat will be contacting the International Commission for the History of Mathematics in order to insure its active participation in this event.

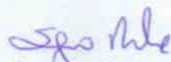

Sergio Nobre

President of the Brazilian Society
of History of Mathematics

Member of the Executive Committee of the
International Commission for the History of
Mathematics

Sociedade Brasileira de História da Matemática
SBHMat, C.P. 68, 13500-970 - Rio Claro - SP - Brasil
sbhmat@rc.unesp.br www.sbhmat.com.br

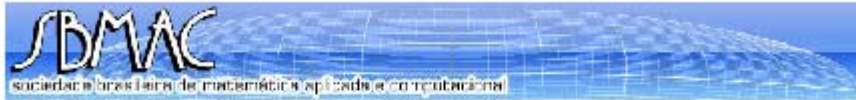

October 06th, 2008.

Prof László Lovász
President of the International Mathematical Union

Dear Prof Lovász,

It is with great satisfaction that SBMAC, the Brazilian Society for Applied and Computational Mathematics, expresses its support to the Brazilian bid to hold the International Congress of Mathematicians 2014 in Rio de Janeiro.

The realization of the ICM in Brazil will be a remarkable contribution to the development of Mathematics in our country and in Latin America as whole, with a particularly strong impact amongst our young colleagues and students.

We look forward to welcoming the international mathematical community to Brazil in 2014.

Very best regards.

A handwritten signature in black ink, appearing to read 'J. A. Cuminato', is written over a light blue grid background.

José Alberto Cuminato
President of SBMAC

1



MINISTÉRIO DA EDUCAÇÃO
UNIVERSIDADE FEDERAL DO CEARÁ
PRÓ-REITORIA DE PESQUISA E PÓS-GRADUAÇÃO
DIVISÃO DE APOIO ADMINISTRATIVO



OFÍCIO Nº 0773/2008 - PR/PPG

Fortaleza, 28th August 2008.

Dear Professor,

The Universidade Federal do Ceará - UFC is proud to be associated with the Brazilian candidacy to host the International Congress of Mathematicians ICM 2014.

UFC is a federal research university with about 30,000 students and 1,500 faculty members. Its Department of Mathematics trains some 4,000 undergraduate students in Science and Engineering, and also hosts a very successful graduate program.

We are certain that the realization of the ICM in Rio de Janeiro will be a pivotal moment in the history of Mathematics in our region that will command great enthusiasm from our students and professors.

We commit our full support to this initiative and hope it will receive a most positive reception from IMU.

Very best regards,

Prof. Gil de Aquino Farias
Pró-Reitor de Pesquisa e Pós-Graduação

PROF. LAZLÓ LOVÁSZ
President
International Mathematical Union

Pró-Reitoria de Pesquisa e Pós-Graduação
Av. Mister Hull, s/n - Campus do Pici - Bloco 848 - CEP 60.021-970 - Caixa Postal 12.140
Tel: (85)3366-9943 / 3366-9942 - Fax: (85)3366-9941
Website: <http://www.prppg.ufc.br> - E-mail: prposufa@ufc.br



Universidade de Brasília
Decanato de Pesquisa e Pós-Graduação

Brasília, September 2, 2008

OFÍCIO Nº 100/DPP

Professor László Lovász
President of the International Mathematical Union

Dear Professor Lovász,

The Universidade de Brasília – UnB is honored to support Brazil's candidacy to host the International Congress of Mathematics ICM 2014.

UnB is a federal research university with about 25,000 undergraduate students, 5,000 graduate students and 1,500 faculty members. The Department of Mathematics serves more than 8,000 undergraduate students in Science and Engineering annually, besides hosting one of the leading graduate programs in Mathematics in Brazil.

There is no doubt that choosing Rio de Janeiro to host the next ICM will contribute greatly to the development of Mathematics in Brazil.

We fully support this initiative and hope it will receive a most positive reception from IMU.

Sincerely yours,

Marco Amato
Dean for Research and Graduate Studies
Universidade de Brasília

Prédio da Reitoria – 3º andar
Campus Universitário Darcy Ribeiro
Brasília – DF 70910-900

Telefones: (61) 3274 1362 (61) 3307 2295
Fax: (61) 3307 2065
www.unb.br/dpp dppunb@unb.br



UNIVERSIDADE FEDERAL DE MINAS GERAIS
GABINETE DO REITOR

OFÍCIO GR. Nº 372/2008

August 28, 2008.

Dear Professor Lovász:

The Universidade Federal de Minas Gerais - UFMG is proud to support the Brazilian candidacy to host the International Congress of Mathematicians ICM 2014.

UFMG is a federal research university with about 35,000 students and 2,300 faculty members. The Department of Mathematics of our Institution trains about 5,000 undergraduate students in Science and Engineering, and also offers a very reputable and successful graduate program.

We are certain that hosting the ICM in Rio de Janeiro will be a pivotal moment in the history of Mathematics in our region that will involve a strong commitment from our academic community and bring about great enthusiasm from our students, researchers and professors.

We commit our full support to this initiative and hope it will receive a most positive reception from IMU.

We look forward to welcoming the International Congress of Mathematicians ICM in 2014 in Brazil.

Sincerely,

Ronaldo Tadêu Pena
Rector

Professor László Lovász
President of the International Mathematical Union

CG/mrc

L.document/oficio/2008-372

Avenida Antônio Carlos, 6627 - 31270-901 - Belo Horizonte - Minas Gerais
Tel: (31) 3409-4127 - Fax: (31) 3409-4130 - sadm@gabinete.ufmg.br - Home page: www.ufmg.br



Rio de Janeiro, August 13, 2008

Prof László Lovász
President of the International Mathematical Union
International Mathematical Union
Office of the Secretariat
Zuse Institute Berlin
Takustr. 7
D-14195 Berlin - Germany
Fax: 49 30 84185 - 269

Dear prof Lovász,

The Instituto Nacional de Matemática Pura e Aplicada – IMPA - is proud to be associated with the Brazilian candidacy to host the International Congress of Mathematicians ICM 2014.

IMPA is a research institute and graduate school under the aegis of the Ministry of Science and Technology of Brazil. To this date IMPA has granted 295 Ph.D.'s and 641 master's degrees, and the achievements of his researchers have earned it a worldwide reputation as a center of excellence.

We are certain that the realization of the ICM in Rio de Janeiro will be a pivotal moment in the history of Mathematics in our region, and that it will command great enthusiasm from our students and professors. We commit our full support to this initiative and hope it will receive a most positive reception from IMU.

Very best regards,

Alfredo Iusem
Chair of Scientific Activities

Estrada Dona Castorina, 110 Rio de Janeiro - Brasil 22460-320 Fone: 55 21 2529 5000 Fax: 55 21 25295019
<http://www.impa.br>



MINISTÉRIO DA EDUCAÇÃO
UNIVERSIDADE FEDERAL DE PERNAMBUCO
GABINETE DO REITOR
Av. Prof. Moraes Rego, 1235 – Cidade Universitária – Recife/PE
CEP. 50670.901 – Tel. 55 81 2126.8001/8002 – Fax. 55 81 2126.8029
gabinete@ufpe.br

Ofício nº 666 /2008-GR

Recife, september 30 2008.

Prof László Lovász

President of the International Mathematical Union

Dear Prof Lovász,

1. The Universidade Federal de Pernambuco (UFPE) is proud to be associated with the Brazilian candidacy to host the International Congress of Mathematicians ICM 2014.
2. UFPE is a federal research university with about 26,000 students and 1,700 faculty members. Its Institute of Mathematics trains some 4,500 undergraduate students in Science and Engineering, and also hosts a very successful graduate program.
3. We are certain that the realization of the ICM in Rio de Janeiro will be a pivotal moment in the history of Mathematics in our region that will command great enthusiasm from our students and professors.
4. We commit our full support to this initiative and hope it will receive a most positive reception from IMU.

Very best regards,

Prof. Amaro Henrique Pessoa Lins
Rector

Ofício ao Presidente da União Internacional de Matemática solicitando apoio para realização de evento na UFPE em 2014/Diversos/Ofícios/Secretaria/ prsm



Rio de Janeiro, 08th August 2008

Prof. László Lovász
President of the International Mathematical Union

Dear Prof. Lovász,

The Pontifícia Universidade Católica do Rio de Janeiro – PUC-Rio is proud to be associated with the Brazilian candidacy to host the International Congress of Mathematicians ICM 2014.

PUC-Rio is a private research university with about 17338 students and 1249 faculty members. The Department of Mathematics trains some 4336 undergraduate students within the Science and Engineering Center, Economics and Business and also hosts a very successful postgraduate and graduate program.

We are certain that the realization of the ICM in Rio de Janeiro will be a pivotal moment in the history of Mathematics in Brazil and Latin America that will command great enthusiasm from our student and professors.

We commit our full support to this initiative and hope it will receive a most positive reception from IMU.

Very best regards,

Paulo Cesar Duque Estrada
Associate Vice-President for Graduate Programs
and Research

Departamento de Matemática
Rua Marquês de São Vicente, 225 - Gávea - 22453-900
Rio de Janeiro - RJ - fax: (021) 35271282 tel. 35271727 email: depto@mat.puc-rio.br



UNIVERSIDADE DO ESTADO DO RIO DE JANEIRO

Sub-reitoria de Pós-graduação e Pesquisa
Rua São Francisco Xavier, 524 - sala T- 061 – bloco F
Maracanã – RJ CEP 20.559-900
Telefone 2587-7105 – 2587.7403 - 2569.5396
Endereço eletrônico: sr2@uerj.br

Rio de Janeiro, 12 September, 2008.

OF. 123/SR-2/2008

Prof. László Lovász
President of the International Mathematical Union

Dear Professor Lovász,

The Rio de Janeiro State University (UERJ) is proud to be associated with the Brazilian application to host the International Congress of Mathematicians ICM 2014.

UERJ is a state University with about 23000 students and 2200 faculty members. Its Mathematics and Statistics Institute trains some 9000 undergraduated students in many areas.

We are certain that the organization of the ICM in Rio de Janeiro will be very important moment in the history of Mathematics in our region that will get great enthusiasm from our students and professors.

We declare our full support to this initiative and hope it will receive a most positive reception from IMU.

Best regards,

Monica Heilbron
Vice-chancellor for Post-graduation Studies and Research

Rua São Francisco Xavier, 524 - sala T.061- Campus UERJ - Maracanã -
Rio de Janeiro - Brasil - CEP 20559-900 - Tel.: 2569-5396 - 2587-7105 / 2587 -7403



UNIVERSIDADE FEDERAL
DO RIO DE JANEIRO
UFRJ

PRÓ-REITORIA DE
PÓS-GRADUAÇÃO E PESQUISA
PR2

Rio de Janeiro, 26th June 2008.

Prof. László Lovász
President of the International Mathematical Union

Dear Prof. Lovász,

The Universidade Federal do Rio de Janeiro (UFRJ) is proud to be associated with the Brazilian candidacy to host the International Congress of Mathematicians ICM 2014.

UFRJ is a federal research university with about 45.000 students and 3.300 faculty members. Its Institute of Mathematics trains some 10.000 undergraduate students in Science and Engineering, and also hosts a very successful graduate program.

We are certain that the realization of the ICM in Rio de Janeiro will be a pivotal moment in the history of Mathematics in our region that will command great enthusiasm from our students and professors.

We commit our full support to this initiative and hope it will receive a most positive reception from IMU.

Very best regards,

Angela Uller
Pró-Reitora de Pós-Graduação e Pesquisa
RG/PRJ 0361092

Avenida Pedro Calmon nº 550 - Prédio da Reitoria - Ilha do Fundão
Cidade Universitária - 8º andar - Sala 801 - Rio de Janeiro - RJ / Brasil
CEP: 21941-901 - E-mail: pro-reitor@pr2.ufrj.br - Home <http://www.pr2.ufrj.br>
Tel.: (0xx21) 2598-9622 - Fax: (0xx21) 2598-1806



SERVIÇO PÚBLICO FEDERAL
Ministério da Educação
Universidade Federal Fluminense

Prof László Lovász
President of the International Mathematical Union

Dear prof Lovász,

The Universidade Federal Fluminense - UFF is proud to be associated with the Brazilian candidacy to host the International Congress of Mathematicians ICM 2014.

UFF is a federal research university with about 20,000 students and 2,000 faculty members. Its Institute of Mathematics trains some 5,000 undergraduate students in Science and Engineering, and also hosts a very successful graduate program.

We are certain that the realization of the ICM in Rio de Janeiro will be a pivotal moment in the history of Mathematics in our region that will command great enthusiasm from our students and professors.

We commit our full support to this initiative and hope it will receive a most positive reception from IMU.

Very best regards,

Prof. Humberto Fernandes Machado
Pró-Reitor de Pesquisa e Pós-Graduação
Humberto Fernandes Machado
Pró-Reitor de Pesquisa e Pós-Graduação
Matricula SIAPE 0307246-0

Rua Miguel de Frias, 9, 3º andar, Icaraí, Niterói/RJ - Brasil - 24220-000
Telefax: 55 (21) 2620-6419, 2621-2249 e 2717-1574
<http://www.propp.uff.br>
propp@propp.uff.br



Prof László Lovász
President of the International Mathematical Union

Dear prof Lovász,

The Universidade Federal do Rio Grande do SUL - UFRGS is proud to be associated with the Brazilian candidacy to host the International Congress of Mathematicians ICM 2014.

UFRGS is a federal research university with about 25.000 students and 2.000 faculty members. Its Institute of Mathematics trains thousand of undergraduate students in Science and Engineering, and also hosts a very successful graduate program.

We are certain that the realization of the ICM in Rio de Janeiro will be a pivotal moment in the history of Mathematics in our region that will command great enthusiasm from our students and professors.

We commit our full support to this initiative and hope it will receive a most positive reception from IMU.

Very best regards,

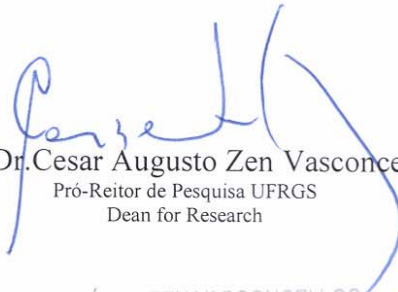
Prof. Dr. Cesar Augusto Zen Vasconcellos
Pró-Reitor de Pesquisa UFRGS
Dean for Research

CÉSAR ZEN VASCONCELLOS
Pró-Reitor de Pesquisa
PROPESQ/UFRGS



UNIVERSIDADE FEDERAL DE SÃO CARLOS
PRÓ-REITORIA DE PÓS-GRADUAÇÃO
E PESQUISA
Via Washington Luís km 235, Caixa Postal 676
13560-970 - São Carlos - SP
Fones: (16) 3351 8109 / 3351 8110
Fax: (16) 3361 3176
propg@power.ufscar.br / www.propg.ufscar.br



Of. ProPG nº 298/2008

São Carlos, 05 de setembro de 2008.

Prof. László Lovász
President of the International Mathematical Union

Dear Prof Lovász:

The Universidade Federal de São Carlos - UFSCar is proud to be associated with the Brazilian candidacy to host the International Congress of Mathematicians ICM 2014.

UFSCar is a federal research university with about 15,000 students and 800 faculty members. Its Department of Mathematics trains some 3,000 undergraduate students in Science and Engineering, and also hosts a very successful graduate program.

We are certain that the realization of the ICM in Rio de Janeiro will be a pivotal moment in the history of Mathematics in our region that will command great enthusiasm from our students and professors.

We commit our full support to this initiative and hope it will receive a most positive reception from IMU.

Sincerely,

Romeu C. Rocha-Filho
Dean of Graduate Studies

Claudio S. Kiminami
Dean of Research

Prof László Lovász

President of the International Mathematical Union

São Paulo, September 18th, 2008

Dear Prof Lovász,

The Universidade Estadual Paulista "Julio de Mesquita Filho" - UNESP is honored to support the Brazilian candidacy to host the International Congress of Mathematicians - ICM 2014.

Throughout its 30 years of history, UNESP has consolidated a project joining scientific, technological, economic, cultural and social development committed to democratic principles and clearly conscious of its status of a governmental institution, inserted and highly active in Brazilian society.

The interaction of UNESP with different sectors of society exerts a strong influence on its social landscape. Its elevated qualification level can be confirmed through the expressive number of former students inserted in the professional market, as well as its top position in national academic ranks regarding all fields where it is present.

UNESP is the most successful model of a multi-campus university in Brazil. Such unique characteristic allows intense and diversified activities in Sao Paulo, the most developed State in the country. Its influence can be recognized by the level of regional development where its campuses are located: one in the State capital and 22 others strategically distributed throughout the State. Its 40 schools offer 168 undergraduate programs and 174 graduate programs at Master and Doctorate levels offered to over 46,000 students in nearly every knowledge areas. UNESP is also one of the most productive institutions regarding research activities, with over 5000 projects.

UNESP supports this application and is certain that the ICM taking place in Rio de Janeiro in 2014 will be important in the history of Mathematics and also generate immediate and future benefits to our mathematical community.

Sincerely,



Marcos Macari
President

Rua Quirino de Andrade, 215 – Centro – São Paulo - SP CEP 01049-010
Fones: (11) 5627-0608 / 0519 / 0216 / FAX (11) 5627-0103



Prof. László Lovász

President of the International Mathematical Union

Dear Prof. Lovász,

The University of São Paulo, USP, is proud to be associated with the Brazilian candidacy to host the International Congress of Mathematicians ICM – 2014.

The University of São Paulo is a state research university with about 80.000 students and 5.500 faculty members. Each year, 2.300 students obtain their PhD degrees in one of its several graduate programs, the highest such number among the universities in the world.

USP has two institutes completely involved with mathematical sciences. They train some 3.300 undergraduate students in Mathematics, Statistics and Computer Sciences and also host very successful graduate programs (with approximately 900 graduate students).

We are certain that the realization of the ICM in Rio de Janeiro will be a pivotal moment in the history of Mathematics in our region that will command great enthusiasm from our students and professors.

We commit our full support to this initiative and hope it will receive a most positive reception from IMU.

Very best regards,

Armando Corbani Ferraz
Provost

PRO
REITORIA
Pós-Graduação 

Pró-Reitoria de Pós-Graduação
Rua da Reitoria, 109 . Térreo . sala 18 . 05508-900 . São Paulo-SP
Tel: 55 (11) 3091.3266 / 3190 . Fax: 55 (11) 3816.7691
prpg@usp.br www.usp.br/prpg



Sociedade Portuguesa de Matemática
Av. da República 45, 3º Esq
1050-187 Lisboa

Tel 21 793 9785 / Fax 21 795 2349
www.spm.pt spm@spm.pt

Lisbon, October 15, 2008

Prof. László Lovász
President of the International Mathematical Union

Dear Prof. Lovász,

I would like to express the enthusiastic support of the Portuguese Mathematical Society (SPM) to the Brazilian candidacy to organize the 2014 International Congress of Mathematicians in Rio de Janeiro.

Relations between the mathematical communities of Portugal and Brazil, which have deep historical roots, have been acquiring a whole new dimension in recent years, as joint research works, exchange of graduate students, joint organization of meetings, and other forms of scientific collaboration, become increasingly common. This has, certainly, had a significant role in the development Mathematics has been experiencing in my country in the last decades.

The ICM2014 in Rio de Janeiro will provide a privileged occasion for further enhancing the links between the two communities, and we look forward to this great opportunity.

Best regards,

A handwritten signature in black ink that reads 'Nuno Crato'.

Nuno Crato
(SPM President)



UNIÓN MATEMÁTICA ARGENTINA
Carlos Cabrelli

Buenos Aires, September 8, 2008

Prof László Lovász
President of the
International Mathematical Union

Dear Prof. Lovász

We would like to express the enthusiastic support of the Union Matemática Argentina to the Brazilian candidacy to host the International Congress of Mathematicians ICM 2014.

Active collaboration between Argentinians and Brazilian scientists and institutions is an important ingredient in the clear and steady development Mathematics has been experiencing in Argentina over the last decades.

The realization of the International Congress of Mathematicians in Rio de Janeiro, for the first time ever in Latin America, will constitute a major event for the mathematical community in the whole region.

Best regards,

Carlos Cabrelli
President
Unión Matemática Argentina

*Departamento de Matemática
Ciudad Universitaria - Pabellón I
C1428EGA Buenos Aires - ARGENTINA*

TEL/FAX: (54) - (11) 4576-3335
uma@dm.uba.ar



Buenos Aires, August 11, 2008

Prof László Lovász
President of the International Mathematical Union

Dear Professor Lovász,

We would like to express the enthusiastic support of the Instituto Argentino de Matemática to the Brazilian candidacy to host the International Congress of Mathematicians ICM 2014.

Active collaboration between Argentinian and Brazilian scientists and institutions is an important ingredient in the clear and steady development Mathematics has been experiencing in Argentina over the last decades.

The realization of the International Congress of Mathematicians in Rio de Janeiro, for the first time ever in Latin America, will constitute a major event for the mathematical community in the whole region.

Best regards,

GUSTAVO CORACH
DIRECTOR
INSTITUTO ARGENTINO DE MATEMATICA

Saavedra 15 - 5er. Piso - C1083ACA - Buenos Aires - TE: 4954-6781/82 - FAX: 4954-6782
E-mail: iam@conicet.gov.ar Web: www.iam-conicet.gov.ar



FACULTAD DE CIENCIAS EXACTAS Y NATURALES
Departamento de Matemática

Universidad de Buenos Aires

Ursula Molter, Chair

Buenos Aires, September 13, 2008

Prof László Lovász
President of the
International Mathematical Union

Dear Prof. Lovász

On behalf of the Department of Mathematics of the Fac. of Exact and Natural Sciences of the University of Buenos Aires, I would like to express our enthusiastic support to the Brazilian candidacy to host the International Congress of Mathematicians ICM 2014.

Active collaboration between Argentinians and Brazilian scientists and institutions is an important ingredient in the clear and steady development Mathematics has been experiencing in Argentina over the last decades.

The realization of the International Congress of Mathematicians in Rio de Janeiro, for the first time ever in Latin America, will constitute a major event for the mathematical community in the whole region.

Please, do not hesitate if you would like to request any further collaboration from our side.

Best regards,

A handwritten signature in black ink that reads 'Umolter'.

Ursula Molter
Chair
Department of Mathematics
University of Buenos Aires

Ciudad Universitaria - Pabellón I
C1428EGA Buenos Aires - ARGENTINA

Teléfono: (54) - (11) 4576-3335
FAX: (54) - (11) 4576-3335



Córdoba, october 10th 2008

Professor Laszlo Lovasz
President of the
International Mathematical Union

Dear Prof. Lovasz,

I am sending this letter to express the enthusiastic support of C.I.E.M. (Centro de Investigaciones y Estudios de Matemática de Córdoba, Argentina) to the Brazilian candidacy to host the ICM 2014 in Rio de Janeiro. We believe that mathematical research is showing a steady growth in Latin America, particularly in Brazil who plays an important role in the region through the organization of international meetings and the direction of graduate students coming from all of Latin America.

We feel that the realization of the International Congress of Mathematicians in Brazil will be important for the development of Mathematics in the whole region, and in particular it will have a most positive influence in the mathematical community in Argentina.

Sincerely your,

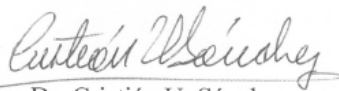
Dr. Cristián U. Sánchez
Director del CIEM

CENTRO DE INVESTIGACION Y ESTUDIOS DE MATEMATICA DE CORDOBA
FaMAF - UNC
Medina Allende s/n - Ciudad Universitaria - 5000 CORDOBA - Argentina
Tel: (0351) 433-4051/2 int. 381 Fax: (0351) 4334054
e-mail: ciem@mate.uncor.edu Web: <http://www.famaf.unc.edu.ar/~ciem/>

FROM :

PHONE NO. :

Oct. 19 2008 03:30AM P2



Universidad Nacional de Córdoba
FACULTAD DE MATEMÁTICA, ASTRONOMÍA Y FÍSICA

Córdoba, 17 de Octubre de 2008

Professor Laszlo Lovasz
President of the International Mathematical Union

Dear Prof. Lovasz,

It was a pleasure for us to know that Brazil is a candidate to host the ICM 2014 in Rio de Janeiro. We want to let you know that the Facultad de Matemática, Astronomía y Física (FAMAF), Universidad Nacional de Córdoba, is a firm supporter of this candidacy.

There are several reasons for this decision. We consider that Mathematics must be strengthened in Latin America and there are several evidences that the efforts on this direction can produce great results. We believe that mathematical research is showing a steady growth in the region, particularly in Brazil who has a considerable mathematical production and plays an important role through the education of researchers, particularly in the direction of graduate and undergraduate students coming from all of Latin America. It is also remarkable that Brazil has a great experience on the organization of international meetings.

We feel that this opportunity will produce a considerable impact in Argentina and particularly in Córdoba. Our institution is one of the most important research and educational center of Mathematics in the country. We have a Mathematics PhD Program of 25 years old with more than 60 finished thesis and 41 graduate students in the area. We plan to organize a satellite congress in case the ICM2014 is in Brazil and, for our limited financial possibilities, its realization will permit us to invite important researchers to our place.

We believe that the realization of the International Congress of Mathematicians in Brazil will be important for the development of Mathematics in the whole region and could be the first time that Latin America to be the host of a the International Congress of Mathematicians.

Sincerely yours,



Dr. ESTHER GALINA
VICERRECTORA
FAMAF



INSTITUTO DE CHILE
ACADEMIA CHILENA DE CIENCIAS
PRESIDENCIA

at Santiago, August 11, 2008

Prof László Lovász
President of the International Mathematical Union

Dear Professor Lovász,

We would like to express the enthusiastic and strongest support of the Chilean Academy of Sciences to the Brazilian candidacy to host the International Congress of Mathematicians ICM 2014.

In the last three decades there has been an active collaboration between Chilean and Brazilian scientists, a pillar of this collaboration being the one in Mathematics which has had a great influence in the development of this discipline in our country.

The realization of the International Congress of Mathematicians in Rio de Janeiro, for the first time ever in Latin America, will constitute a major event for the scientific community in our region.

With our best regards,



Servet Martínez
President
Chilean Academy of Sciences



PONTIFICIA
UNIVERSIDAD
CATÓLICA
DE CHILE

FACULTAD DE MATEMÁTICAS

120 años
EN EL CORAZÓN DE CHILE

Santiago, August 25, 2008

Prof. László Lovász
President of the International Mathematical Union

Dear Prof. Lovász:

We would like to express the enthusiastic support of the Pontificia Universidad Católica de Chile to the Bazilian candidacy to host the International Congress of Mathematicians ICM 2014.

Active collaboration between Chilean and Brazilian scientists and institutions is an important ingredient in the clear and steady development Mathematics has been experiencing in Chile over the last decades.

The realization of the International Congress of Mathematicians in Rio de Janeiro, for the first time ever in Latin America, will constitute a mayor event for the mathematical community in the whole region.

Yours sincerely,



Guillermo Marshall Rivera
Dean
School of Mathematics



GMR/mac

AV VICUÑA MACKENNA 4860, TELÉFONOS 686-4507, FAX 552-5916, SANTIAGO, CHILE

RECTORIA



PONTIFICIA UNIVERSIDAD
CATOLICA
DE VALPARAISO

Valparaíso, September 29th 2008

Mr. Marcelo Viana
Instituto Nacional de Matemática Pura y Aplicada
Estrada Dona Castorina 110, Jardín Botánico
Rio de Janeiro 22460-320
Brasil



Dear Mr. Viana,

It is a great pleasure to express the Pontificia Universidad Católica de Valparaíso's intent to organize the Conference, "Achievements and Challenges in Dynamics 2014 (ICM Satellite Conference)."

It is an honor and a stimulating challenge for our University, and in particular, the Institute of Mathematics, to have the opportunity to receive distinguished specialists from the field of dynamics. Also, this initiative is within the framework of activities that the Institute of Mathematics organizes that field, such as the Seminar on the Dynamics of Valparaíso and the VI School of Dynamics Systems.

Sincerely yours,



Alfonso Muga
Rector

Pontificia Universidad Católica de Valparaíso

pucv.cl

Av. Brasil 2950, Valparaíso, Chile
tel (56-32) 2273200 - 2273201
fax (56-32) 2273393
casilla 4059



SOCIEDAD COLOMBIANA DE MATEMATICAS

A.A. 2521

Edificio Calle 16 No. 9-64, Local 1

Tels. 4811338 – 2438590

www.scm.org.co

Prof László Lovász
President of the International Mathematical Union

Dear prof Lovász,

We would like to express the enthusiastic support of the *Sociedad Colombiana de Matemáticas* to the Brazilian candidacy to host the International Congress of Mathematicians ICM 2014.

The interaction between Colombian scientists and institutions with the global mathematics community and in particular with other south American scientists, is arguably the most important tool and what has enabled the clear and steady development Mathematics has been experiencing in Colombia over the last decades. Being Brazil the most important center for mathematics is the area, we have encountered in Brazilian institutions and scientists a very important support and it is clear to us that this particular contact has facilitated our progress, visibility and interaction with the world community.

The realization of the International Congress of Mathematicians in Rio de Janeiro, for the first time ever in Latin America, will constitute a major event for the mathematical community in the whole region.

Best regards,

Carlos H. Montenegro
President
Sociedad Colombiana de Matemáticas
cmontene@scm.org.co



CIMAT

CENTRO DE INVESTIGACIÓN EN MATEMÁTICAS, A.C.

August 15, 2008

Prof. László Lovász
President of the International Mathematical Union

Dear Prof Lovász,

We would like to express the enthusiastic support of CIMAT to the Brazilian candidacy to host the International Congress of Mathematicians ICM 2014.

The active collaboration between Mexican and Brazilian scientists and institutions is an important ingredient in the clear and steady development Mathematics has been experiencing in Mexico over the last decades.

It is probably true that the strongest relationship is in Dynamical Systems through the IMPA, three of our researchers got their Phd in this area there. But there are a lot of other collaborations with other institutions and areas. Belo Horizonte, Campinas, Porto Alegre, Fortaleza are usual destination for many people working in Algebraic Geometry, Probability and Partial Differential Equations among others.

Brazil, moreover, has been a center that catalyzes relations between other countries in Latin America. Many Mexican-Uruguayan or Mexican-Peruvian relations cannot be understood without the central role of Brazil.

We believe that having the opportunity to organize this important meeting would be a well deserved honor. In recent decades Brazil has reached many significant world class achievements.

The realization of the International Congress of Mathematicians in Rio de Janeiro, for the first time ever in Latin America, will constitute a major event for the mathematical community in the whole region.

Best regards,



Dr. Oscar Adolfo Sánchez Valenzuela
General Director

JALISCO S/N COL. VALENCIANA APDO. POSTAL 402 36000
TEL. (473) 732-7155 FAX (473) 732-5749 GUANAJUATO, GTO., 36240, MÉXICO



UNIVERSIDAD NACIONAL
AUTÓNOMA DE
MÉXICO

INSTITUTO DE MATEMÁTICAS
UNIDAD CUERNAVACA

Cuernavaca, Mexico, August 14, 2008

Prof László Lovász,
President of the International Mathematical Union.

Dear Professor L. Lovász,

This letter is to express the enthusiastic support of our institute to the Brazilian candidacy to host the International Congress of Mathematicians ICM 2014.

We have very close academic ties with Brazil and the collaboration with Brazilian mathematics is key for our institution. For instance: two of our main academic leaders, professors Alberto Verjovsky and José Seade, have spent long periods of time in Brazil and they have written several articles with Brazilian co-authors; in fact Professor Verjovsky actually finished his Ph. D. thesis at IMPA in 1973. Also, one of our young researchers, Aubin Arroyo, finished his Ph. D. at IMPA in 2003, and another of our young researchers, Adolfo Guillot was a postdoc at IMPA two years ago. Two other of our young researchers, Fuensanta Aroca and Jawad Snoussi, were postdocs at the University of Sao Paulo at Sao Carlos. On the other hand, we have at the moment two Brazilian students working for their Ph. D. thesis in our institute. Given that we are only 23 staff members in our institute, the above numbers show the significance of Brazilian mathematics for us.

This active collaboration between mathematicians of Brazil and Mexico has been going on over the last decades in several branches of mathematics, most notably in dynamical systems and singularities theory, but also in partial differential equations, combinatorics, algebra and other areas of mathematics.

The realization of the International Congress of Mathematicians in Rio de Janeiro, for the first time ever in Latin America, would constitute a major event for our mathematical community and no doubt would help to enhance mathematics in the whole region.

Yours sincerely,

Dr. Salvador Perez Esteva
Head of the branch Cuernavaca
of the Instituto de Matemáticas
Universidad Nacional Autónoma de México

A.P. 273-3 ADMON. 3
CUERNAVACA, MOR.
C.P. 62251, MÉXICO

A.P. 6-60 ADMON. 6
CUERNAVACA, MOR.
C.P. 62131, MÉXICO

TELEFONOS:
91 (73) 291722
91 (5) 6227722
FAX:
91 (73) 170044

INTERNET:
dir@matcuern.unam.mx
<http://www.matcuern.unam.mx>



UNIVERSIDAD NACIONAL
AUTÓNOMA DE
MÉXICO

INSTITUTO DE MATEMÁTICAS

AREA DE LA INVESTIGACION CIENTIFICA
CIRCUITO EXTERIOR
CIUDAD UNIVERSITARIA
MEXICO, D. F. C. P. 04510
<http://www.matem.unam.mx>

Mexico City, September 17 of 2008.

IMAT/D32/2008.

Prof László Lovász,
President of the International Mathematical Union.

Dear Professor L. Lovász,

We would like to express the enthusiastic support of the Instituto de Matemáticas of the National University of Mexico (UNAM), to the Brazilian candidacy to host the International Congress of Mathematicians ICM 2014.

There has been an active collaboration between mathematicians of Brazil and Mexico over the last decades in several branches of mathematics, as for instance in dynamical systems, partial differential equations, combinatorics, algebra and singularities theory. Also, several of our former students have done graduate studies in Brazil and some of them are nowadays key mathematicians in Mexico. We may thus say that the collaboration with Brazil has been an important ingredient in the clear and steady development of mathematics in Mexico.

The realization of the International Congress of Mathematicians in Rio de Janeiro, for the first time ever in Latin America, will constitute a major event for the mathematical community in the whole region.

Best regards,

Dr. Javier Bracho Carpio
Director.



INSTITUTO DE MATEMÁTICAS
DIRECCION



Sociedad Científica del Paraguay

87 años en pro de la Investigación y Difusión de las Ciencias

August 28, 2008

Prof László Lovász
President of the International Mathematical Union

Dear Prof Lovász,

We would like to express the enthusiastic support of the Paraguayan Science Society SCP (Sociedad Científica del Paraguay) to the Brazilian candidacy to host the International Congress of Mathematicians ICM 2014.

Active collaboration between Paraguayan and Brazilian scientists and institutions is an important ingredient in the clear and steady development Mathematics has been experiencing in Paraguay over the last decades.

The realization of the International Congress of Mathematicians in Rio de Janeiro, for the first time ever in Latin America, will constitute a major event for the mathematical community in the whole region.

Best Regards,

Manuel Gill Morlis, MD

Sociedad Científica del Paraguay
Email:



Andrés Barbero 230 y Artigas Tel/Fax: (595) 021 205-438 e-mail scpv@rieder.net.py Asunción - Py.



SOCIEDAD MATEMÁTICA PERUANA

August, 11th 2008

Prof László Lovász
President of the International Mathematical Union

Dear prof Lovász,

We would like to express the enthusiastic support of the Sociedad Matemática Peruana to the Brazilian candidacy to host the International Congress of Mathematicians ICM 2014.

Active collaboration between *Peruvian* and Brazilian scientists and institutions is an important ingredient in the clear and steady development Mathematics has been experiencing in Perú over the last decades.

The realization of the International Congress of Mathematicians in Rio de Janeiro, for the first time ever in Latin America, will constitute a major event for the mathematical community in the whole region.

Best regards,

Renato Benazic
President

dirección teléfono (51-1) 349-1892 - Fax (51-1) 349-9838
Calle Los Biólogos 245 email imca@imca.edu.pe
Urb. San César - La Molina http:// www.somape.org.pe
Lima, Perú



Universidad de la República
FACULTAD DE INGENIERIA
INSTITUTO DE MATEMÁTICA Y ESTADISTICA
"Prof. Ing. Rafael Laguardia"

Av. J. HERRERA Y REISSING N° 565
MONTEVIDEO 11200 - URUGUAY
TEL.: (5982)7110621
WEB: <http://imerl.fing.edu.uy/>

SOCIEDAD **URUGUAYA** DE MATEMATICA Y ESTADISTICA

Σ Y M E

Prof. László Lovász
President of the International Mathematical Union

Dear prof. Lovász,

The Sociedad Uruguaya de Matemática y Estadística (SUME) strongly supports the candidacy of Brazil to host the Internacional Congres of Mathematicians in 2014. Moreover, we plan to be propose a satellite meeting to the Congress

José L. Vieitez
Presidente de SUME



ASOCIACIÓN MATEMÁTICA VENEZOLANA
Apartado 47898, Caracas-1040-A, Venezuela.

Caracas, 1 de agosto de 2008

Professor João Lucas Marques Barbosa
Presidente da Sociedade Brasileira de Matemática
Departamento de Matemática
Universidade Federal do Ceará
Fortaleza, Brasil

Dear Professor Marques Barbosa:

I am pleased to communicate you that the Directive Council of the Asociación Matemática Venezolana supports with enthusiasm the proposal of the Sociedade Brasileira de Matemática regarding the celebration of the International Congress of Mathematicians of 2014 in Rio de Janeiro, Brazil.

It is our believe that holding the ICM 2014 in Latin America will have positive consequences for the development of mathematics in the whole region. Brazil certainly has the possibilities and the conditions to host a successful international congress.

Sincerely,

Carlos A. Di Prisco
Presidente
Asociación Matemática Venezolana

Professor László Lovász
President of the International Mathematical Union

Dear Professor Lovász,

As you know, the Mathematical Union of Latin America and the Caribbean (UMALCA by the Spanish spelling) is an organization of the national Mathematical Societies of countries in the region. UMALCA supports exchange of scholars and students among countries of the region, organizes several graduate schools every year (EMALCAs) and every four years the Latin American Congress of Mathematicians, among other activities.

Among the countries members of UMALCA, Brazil has played a fundamental role: it is the country with highest academic and financial contribution to the organization, additional to other important activities, it hosted the first Latin American Congress of Mathematicians with big success. This leading role is just a consequence of the high level that the Brazilian mathematical community has reached scientifically and politically, both at internal and international level. Active collaboration between mathematicians of the Latin American area and Brazilian scientists and institutions is an important ingredient in the steady development of mathematics in several of the countries of the region. In this context, the candidacy of Brazil to organize and host the International Congress of Mathematicians is well deserved and will, no doubt, have an important impact of the further development of mathematics in the region.

On behalf of the Executive Committee of UMALCA, we express our enthusiastic support to the Brazilian candidacy to host the ICM 2014. The realization of the International Congress of Mathematicians in Rio de Janeiro, for the first time ever in Latin America, will constitute a major event for the mathematical community in the whole region.

UMALCA shall seek for the benefits of this Congress to extend to most countries of the region.

With best regards,

Dr. José Antonio de la Peña
President of the Executive Committee
UMALCA

(J.A. de la Peña
Full Professor, Instituto de Matemáticas, UNAM
jap@matem.unam.mx)



General Information



Rio de Janeiro is a large, cosmopolitan coastal city in the southeast of Brazil, known worldwide as a major destination for tourism and business travel. Here we give an overview of the city; detailed information on specific topics is available in later sections.

Geography

- *Location:* 22°54' S (latitude), 43°14' W (longitude)
- *Area:* 1,182.3 Km²
- *Population:* 6.1 million (2006)
- *Climate:* tropical climate with warm, humid summers and cooler, less humid winters. Average precipitation and daily temperatures are presented in the table below.

MONTH	TEMPERATURE (C)		PRECIPITATION (mm)
	Avg Max	Avg Min	
Jan	29°	23°	114
Feb	28°	23°	105
Mar	28°	23°	103
Apr	27°	22°	137
May	26°	21°	86
Jun	25°	19°	80
Jul	24°	18°	56
Aug	23°	17°	50
Sept	24°	18°	87
Oct	25°	20°	88
Nov	27°	21°	96
Dec	28°	22°	169

Weather statistics for Rio de Janeiro

Main attractions

- *Beautiful nature:* the largest urban forest in the world (Floresta da Tijuca), urban parks, two bays, lagoons, 90 km of beaches and hills covered with tropical forest.
- *A vibrant, hospitable people.*
- *Cultural attractions:* museums, cultural centers, historical buildings.
- *Rich musical scene,* movies and theatres.
- Great choice of *shopping, restaurants and tourist sights.*

Economy

- *Tourism* accounts for 4% of the GDP of Rio de Janeiro state. Roughly 40% of all foreign visitors to Brazil spend some time in Rio during their trips.
- *Other important sectors* of the local economy: oil and natural gas; telecommunications; food and beverages; chemistry and metallurgy; medical drug manufacturing; information technology; and media.



Public transportation

- Extensive, inexpensive *bus system*: essentially all business and tourism areas are directly connected by a single bus trip.
- The *Metrô* integrated underground/bus system: faster option available for trips between downtown, the beach neighborhoods in the South District (*Zona Sul*) and Barra da Tijuca, the central neighborhoods of Maracanã and Tijuca, and other parts of town.
- *Taxi cabs*: a widely available, cost-effective alternative within the main tourism and business areas.

For business and leisure travelers

- About 23,000 *hotel rooms comprising all price ranges*
- A wealth of *local businesses* specializing in all aspects of *event organization*.
- Over 500 *tourism agencies*.
- World-class regular/mobile *telephone services*.
- *Broadband Internet access* is widely available, including at most hotels.

Security matters

- The local *Joint Committee for Tourist Security* can be summoned to provide special security for congresses, events and large groups of visitors.
- The Committee is comprised of State Security Secretariat, the Police Force, the Fire Department, the local Tourism Bureau, and other organizations.

Awards and recognition

The top destination for international meetings in the Americas in the last decade, according to ICCA (International Congress and Convention Association).

World Travel Awards (the British edition of the Travel Weekly magazine) chose Rio de Janeiro as *the best South American tourist destination*, and Riocentro as *the best South American Convention Center*, in 2003 and 2004.

The 2001 *World Capital of Friendliness* according to a study conducted by the Universities of Michigan and California.

24,000 readers of the British newspaper **The Guardian** chose Rio de Janeiro as their *6th favorite tourist destination worldwide*, for their 2003 travel edition.



Visas to Brazil

- *Strict reciprocity*: citizens of countries that do not require visas from Brazilians are exempt from (tourist and business) visa requirement to enter Brazil.
- *Brazilian consulates* are present in most countries of the world. Brazilian authorities actively support the *free circulation of scientists* of all origins.
- Most European and South American travelers *do not need visas*. As of 2008, visas are *not* required for visitors from:

Andorra	Hong Kong	Portugal
Argentina	Honduras	Philippines
Austria	Hungary	Republic Central Africa
Bahamas	Israel	Romania
Barbados	Italy	San Marino
Belgium	Iceland	Slovakia
Bolivia	Ireland	Slovenia
Bulgaria	Liechtenstein	South Africa
Chile	Luxemburg	South Korea
Colombia	Monaco	Spain
Czech Republic	Morocco	Suriname
Costa Rica	Macao	Sweden
Croatia	Malasia	Switzerland
Denmark	Malta	Turkey
Ecuador	New Zealand	Tunisia
Finland	Norway	Trinidad & Tobago
France	Namibia	Thailand
Germany	Netherlands	Uruguay
Great Britain	Panama	Vatican
Greece	Paraguay	Venezuela
Guatemala	Peru	
Guyana	Poland	



Mathematics in Brazil

A Brief History of Brazilian Mathematics

Brazilian Mathematics is quite young. Although pioneer works can be traced back to the 1850's, regular activities took off only in the 1950's, when Brazil joined the International Mathematical Union, the Brazilian Mathematical Colloquium was first held, and a number of important institutions were founded.

In the second half of the nineteenth century, Technical Schools were created in Rio de Janeiro and São Paulo to become the forefront of scientific and technological education in Brazil. The first graduate programs in Mathematics were founded in the 1930's, with the creation of the Faculty of Philosophy, Sciences, and Letters of the University of São Paulo, and the National Faculty of Philosophy of the University of Brazil, later to be renamed Federal University of Rio de Janeiro.

Among the generation trained at the University of Brazil in Rio de Janeiro, two names deserve to be mentioned: Mauricio Matos Peixoto and Leopoldo Nachbin. Besides helping creating the Instituto de Matematica Pura e Aplicada (IMPA) in 1952, they were also the first Brazilian mathematicians to give invited addresses to the ICM, at Stockholm 1962 and Vancouver 1974, respectively.

A landmark in the history of Brazilian Mathematics is the organization of the first Brazilian Mathematical Colloquium in 1957. The Colloquium was conceived as a broad meeting congregating the whole national mathematical community, and has been held biannually ever since. The Colloquium has provided a privileged occasion for exchange of ideas and information among Brazilian mathematicians, and has attracted a large number of talented undergraduates to the mathematical career. Several important books in the national mathematical literature, both elementary and advanced, started out as lecture notes for the Colloquium.

In the 1950's and 1960's, aiming at promoting scientific and technological development in Brazil, federal agencies supported talented students to pursue high level scientific training abroad. As a result, a new generation of mathematicians emerged. Regular graduate programs in Mathematics in Brazil would be initiated in the 1960's, irradiating from IMPA and the University of São Paulo. The Brazilian Mathematical Society (SBM) was founded in 1969 and became the country's adhering organization to the IMU.

Development accelerated in the 1970's, when definite policies for expansion and consolidation of the national scientific system, including a strategic planning of graduate studies, were put in place by the federal government. The importance of Mathematics for the overall development of science and technology in the country earned it a special treatment at that stage.

Other mathematical societies were then created, including the Brazilian Society for Applied and Computational Mathematics (SBMAC), the Brazilian Statistics Association (ABE), the Brazilian Society for Mathematical Education (SBEM), and the Brazilian Society for History of Mathematics (SBHMAT).

Extending the idea of the Brazilian Mathematical Colloquium, starting from 2002 the SBM has been organizing the *Bienal da Matemática*, a biannual meeting devoted to the teaching of Mathematics at all levels.

For many years the *Olimpíada Brasileira de Matemática* (OBM) has been promoting regional and national mathematical Olympiads, as well as Brazil's highly successful participation in international Olympiads of Mathematics. Recently, a new national Olympiad (OBMEP) for public school students was started. In its latest edition, OBMEP applied its first tests to more than 18 million students.

The progress attained in the last half century is quite remarkable. The number of Brazilian mathematicians has increased from a few dozens to about one thousand active researchers. Research activity in Brazil currently covers most main areas of Mathematics and several applications, and it has been spreading to the whole national territory. There are currently 46 graduate programs in Mathematics and Statistics which train an increasing number of Brazilian students and a substantial number of foreign students, especially from Latin America, and increasingly from Asia, Europe and North America.

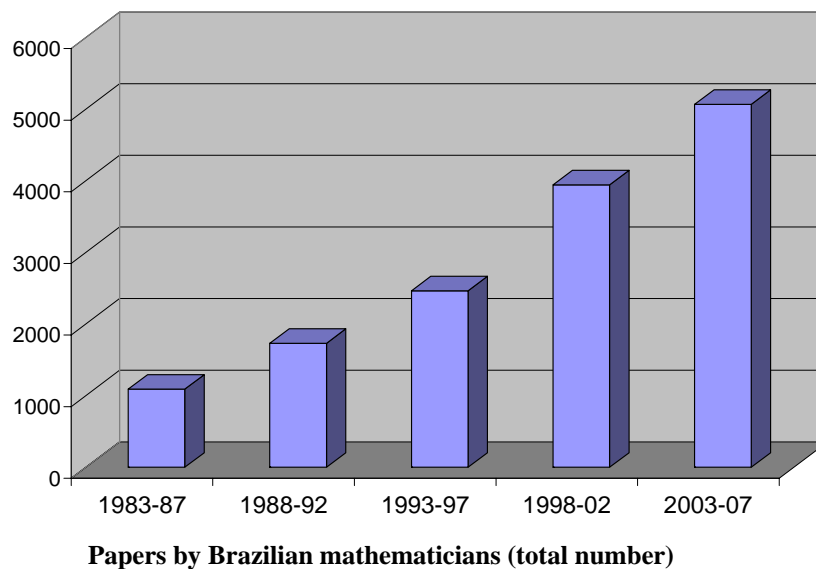

The MathSciNet database lists a little over 14,000 research articles by mathematicians working in Brazil in the last 25 years, covering a very wide spectrum of Mathematics. A substantial fraction of them have been published in the top journals, as shown in the table below.

Journal	Articles
Acta Mathematica	6
American Journal of Mathematics	12
Annals of Probability	44
Annals of Statistics	3
Annales de l'Institut Henri Poincaré (Analyse Non-Linéaire)	21
Annales de l'Institut Henri Poincaré (Probabilités et Statistique)	18
Annales de l'Institut Fourier	27
Annals of Mathematics	19
Annales Scientifiques de l'École Normale Supérieure	19
Communications in Algebra	162
Communications in Mathematical Physics	85
Commentarii Mathematici Helvetici	28
Compositio Mathematica	21
Duke Mathematical Journal	14
Econometrica	5
Ergodic Theory and Dynamical Systems	96
Inventiones Mathematicae	24
Israel Journal of Mathematics	26
Journal of the American Mathematical Society	5
Journal of the American Statistical Association	9
Journal of the European Mathematical Society	5
Journal of Algebra	147
Journal of Algebraic Geometry	5
Journal of Differential Equations	146
Journal of Differential Geom.	17
Journal of Graph Theory	12
Journal of Number Theory	21
Journal fuer die Reine und Angewandte Mathematik	26
Journal of Statistical Physics	143
Mathematische Annalen	38
Mathematics Operational Research	11
Mathematical Programming	44
Mathematische Zeitschrift	41
Nonlinearity	74
Proceedings of the American Mathematical Society	146
Publications Mathématiques I.H.É.S.	9
SIAM Journal of Applied Mathematics	18
SIAM Journal of Computation	6
SIAM Journal of Control Optimization	35
SIAM Journal Mathematical Analysis	28
SIAM Journal Matrix Analysis and Applications	13
SIAM Journal of Numerical Analysis	14
SIAM Journal of Optimization	37
SIAM Journal of Scientific Computation	7
SIAM Reviews	5
Topology	14
Transactions of the American Mathematical Society	85
TOTAL	1791

A sample of Brazilian mathematical production 1983-2007

Mathematics in Rio de Janeiro

The Rio de Janeiro metropolitan region is a focal point for the Brazilian mathematical community and a hub for international Mathematics. The area is home to four research universities and two institutes in the mathematical sciences.

Universidade Federal do Rio de Janeiro (UFRJ)

Pontifícia Universidade Católica do Rio de Janeiro (PUC-Rio)

Universidade Federal Fluminense (UFF)

Universidade Estadual do Rio de Janeiro (UERJ)

Laboratório Nacional de Computação Científica (LNCC)

Instituto Nacional de Matemática Pura e Aplicada (IMPA)

Mathematicians in Rio have also made an impact in technological innovation, especially in the oil industry. Over the last 15 years, semi-public company Petrobrás has invested significant resources in the mathematical modeling of oil reservoirs, simulations of fluid flow and analysis of seismic data. Local applied mathematicians have been greatly involved in such projects.

The area plays a prominent role in the Latin American mathematical community, not only through research, but also thanks to its far-reaching educational programs. Many of the continent's best mathematicians have spent time in the region as graduate students or post-doctoral researchers.

Conferences, workshops and other events are an integral part of mathematical life in Rio. These events bring the cutting edge of research to the local community and promote international collaborations. There is great involvement of local mathematicians and institutions in event organizing. IMPA alone has helped organize more than 40 events between 2003 and 2008, ranging from small workshops to conferences with more than 1000 participants. Some major events that took place in Rio and/or were co-organized by local institutions in the last five years include:

- *Brazilian Mathematical Colloquium (2003, 2005, 2007)*, a biannual gathering of Brazilian and foreigner mathematicians at IMPA with well over 1000 participants.
- *International Congress on Mathematical Physics (ICMP) 2006*, the first time the ICMP took place outside of Europe and the United States;
- *International Symposium on Mathematical Programming (ISMP) 2006*, also the first in its series to take place outside of Europe and the United States;
- *Annual Meeting of the Institute for Mathematical Statistics (IMS) 2006*;
- *First Joint Meeting of the American Mathematical Society (AMS) and the Sociedade Brasileira de Matemática (SBM)*, in 2008.





Scientific Events in Rio

Rio de Janeiro offers efficient infrastructure for holding events of any nature, including airline connections to most major cities in the world, efficient public transportation, a wide variety of hotels and convention centers, which make it a premium choice to host the ICM 2014.

Rio hosted several international meetings in the last decades, including the United Nations Conference on the Environment and Development (Rio Eco 92), when 122 heads of state were present in the city. The 2007 Pan American Games took place in Rio, and the 2014 FIFA World Cup Finals are scheduled for the Maracanã stadium.

Mathematical conferences, workshops and other events are an integral part of academic life in Rio. These events bring the cutting edge of research to the local community and promote international collaborations. There is great involvement of local mathematicians and institutions in event organizing. IMPA alone has helped organize more than 40 mathematical meetings between 2003 and 2008, ranging from small workshops to conferences with more than 1000 participants.

The table below presents a list of some large events recently held in Rio with special emphasis on the last two years.

Event	Year	Participants
Latin American Congress of Mathematicians	2000	1,000
Américas Telecom Rio	2000	27,000
XXIII Brazilian Mathematical Colloquium	2001	1,150
17 th World Petroleum Congress and Rio Oil & Gas	2002	40,000
XXIV Brazilian Mathematical Colloquium	2003	1,150
XXV Brazilian Mathematical Colloquium	2005	1,250
3 rd Conference on HIV Pathogenesis and Treatment	2005	6,000
International Congress of Mathematical Physics	2006	700
11 st Intl Congress of World Federation of Public Health	2006	10,000
IV International Congress of Arthroplastic Surgery	2006	1,500
XIV Scientific International Congress of Esthetic Surgery	2006	4,000
Rio Oil & Gas Conference	2006	3,000
14 th Retina International World Conference	2006	4,000
16 th Intl. Congress of the Interamerican Association of Industrial Property	2006	1,000
1 st International Congress of Sustainable Energy of Kyoto Treaty	2006	2,000
International Seminar on Industrial Uses of Soybean	2007	350
World Congress of Nephrology	2007	6,000
World Congress & Exhibition on Insulators, Arresters and Bushing	2007	400
Pan American Congress on Sport Medicine	2007	500
XXVI Brazilian Mathematical Colloquium	2007	1,232
XIII Congress of the International Liver Transplantation Society	2007	900
Rio Vet Trade Show	2007	7,500
Interseg	2007	10,000
Hospital Business Conference	2007	10,000
13 th International Congress on Immunology	2007	6,000
13 th International Congress of Endocrinology	2008	6,000
Summer Symposium of the Society of Nephrology of Rio de Janeiro	2008	250
International Conference on the Physics of Semiconductors	2008	1,000

Sample of international events held in Rio

Important mathematical meetings that took place in Rio and/or were co-organized by local institutions in the last five years include:

Event	Year	Participants
American Math. Soc. & Soc. Bras. de Matemática: Joint Meeting	2008	375
XX Brazilian School of Algebra	2008	201
Mathematics and Finance: Research in Options	2007	100
XXVI Brazilian Mathematical Colloquium	2007	1,232
Workshop on Mathematical Economics	2006	128
Mathematics and Finance: from Theory to Practice	2006	100
International Symposium of Dynamical Systems	2006	187
International Congress of Mathematical Physics	2006	600
International Symposium on Mathematical Programming	2006	900
IMS Annual Meeting & X Brazilian School of Probability	2006	319
XIV School of Differential Geometry (honoring S.-S. Chern)	2006	318
School and Workshop on Dynamical Systems	2006	168
IX Brazilian School of Probability	2005	108
International Congress on Dynamical Systems	2005	121
XXV Brazilian Mathematical Colloquium	2005	1,250
IX Workshop on Partial Differential Equations	2005	105
VIII Brazilian School of Probability	2004	129
XIV School of Differential Geometry	2004	250
National Symposium of Undergraduate Research	2004	117
XXIX Meeting on Stochastic Processes and Applications	2003	114
XXIV Brazilian Mathematical Colloquium	2003	1,150

Some major mathematical events in the Rio area and/or organized by local institutions.





Convention Centers

Sul-América Convention Center



This Convention Center is located in downtown Rio, within walking distance from *Estácio* subway station, 30 minutes from both airports and 15 minutes from the South District.

The Center can hold up to six thousand people and is divided into two pavements, two mezzanines and an underground parking lot connected by four elevators and four escalators. The total built area amounts to almost 42,000 square meters. Facilities include air conditioning in the whole building, acoustically treated walls, access ramps and Braille signs, wireless internet access, videoconferencing, catering services.

The ground floor includes the main entrance (*Salão Nobre*), the Exhibition Room, the service area and the stairway hall. It is possible to set temporary outdoor activities in the external square.

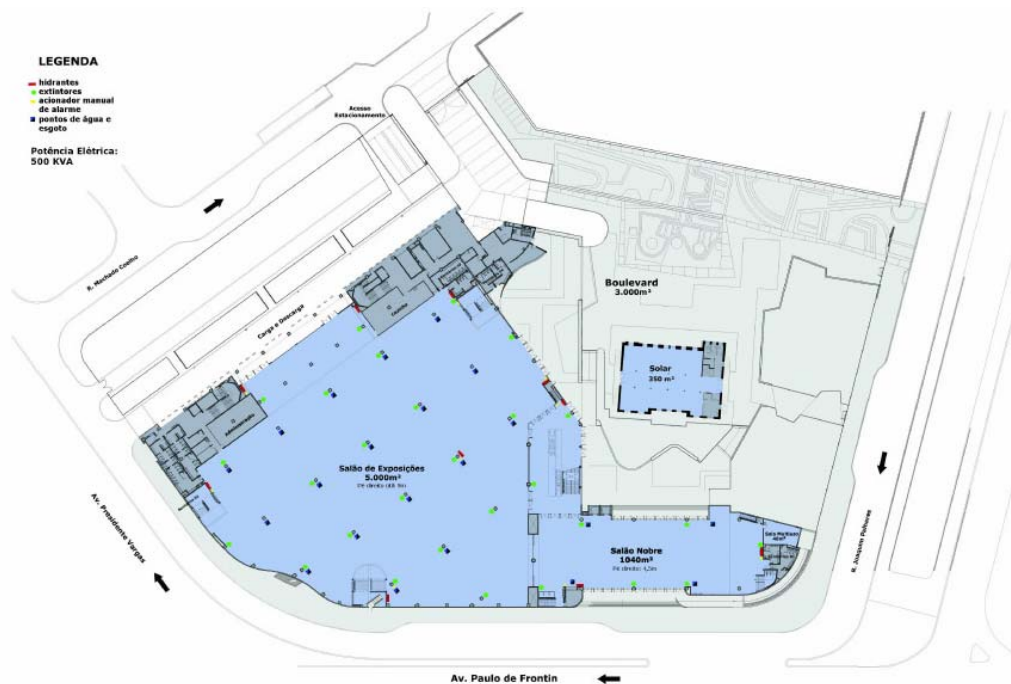

Ground Floor

The second floor holds the Conference and Convention Center. The main Conference Room occupies 2,500 square meters, which can be subdivided into eight large rooms through retractile acoustic panels. The Foyer occupies 2,600 square meters and may be integrated to the Conference Room, creating yet another large space. The second floor also accommodates rooms for meetings, seminars, conferences, workshops and offices, about 120 square meters each.



Second Floor

One of the mezzanines contains five additional rooms and a foyer, while the other is used for storage and technical service.

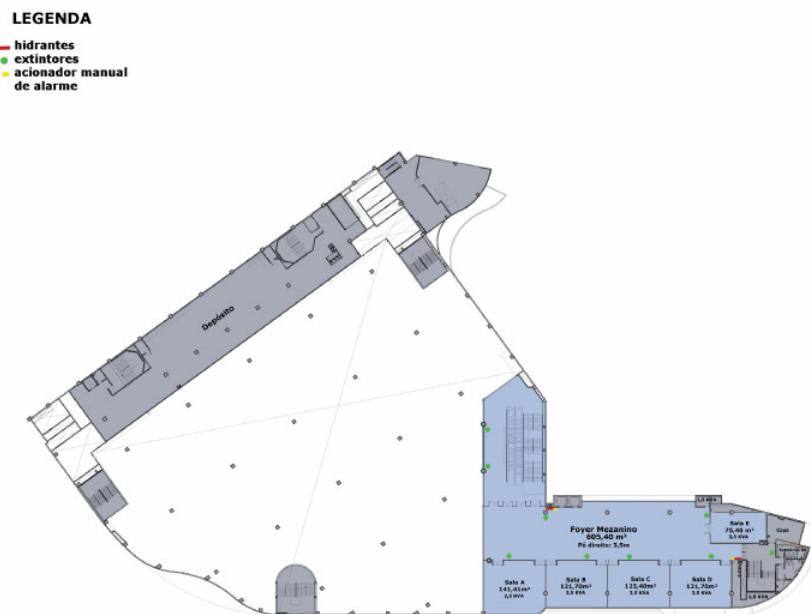

Mezzanine

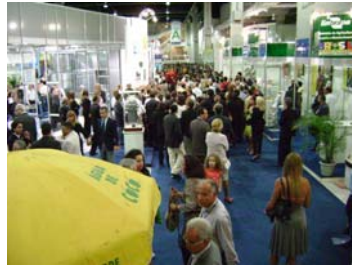

Windsor Hotel



The Windsor Barra Hotel is located across the street from the beautiful beach of Barra da Tijuca, 15km from Ipanema and 18km from Copacabana, with direct access from both airports.

The hotel contains a modern Convention Center, with 26 fully equipped salons occupying over 32,000 square feet. Room capacities vary from 20 to 1200 people, as described in the table below.

Access and reception are independent from hotel. Business center, printers, copiers, wireless internet, phone, fax, and private parking are available.

Rooms	Area (sqm)	Dimensions (m)	Capacity
Underground			
Queluz I	208	24.50 x 8.50	320
Queluz II	222	24.80 x 9	340
Queluz III	226	25.14 x 9	340
Queluz IV	224	25.42 x 9	340
Queluz I, II, III e IV	897	25.42 x 35.3	1380
Queluz I, II, III, IV+Foyer	1020	29 x 35	1560
Ground Floor			
Louvre I	427	24.46 x 17.45	656
Louvre II	446	25 x 17.85	656
Louvre I e II	873	25 x 35	1343
Louvre I e II+Foyer	1015	29 x 35	1560
Chambord	40	10.12 x 4.01	50
Versailles I	262	13.68 x 18.93	340
Versailles II	230	12.14 x 18.93	300
Versailles I e II	492	25.80 x 18.93	680
1st Floor			
Imperial	154	9.32 x 16.51	200
Catete	38	4.07 x 9.50	42
Liberdade	100	10.48 x 9.50	130
Bandeirantes	144	8.67 x 16.62	185
Itamaraty	186	9.50 x 19.55	235
Alvorada I	236	9.24 x 25.52	300
Alvorada II	145	9.50 x 15.30	190
Alvorada I e II	382	9.50 x 40.70	490
2nd Floor			
Alhambra I	257	18.91 x 13.61	365
Alhambra II	229	18.91 x 12.10	305
Escorial	40	4.17 x 9.62	49
Aranjuez	78	9.62 x 8.20	104
Alcazar	31	4.28 x 7.37	35
Oriente	120	12.02 x 9.99	130
El Pardo I	193	9.69 x 19.92	230
El Pardo II	227	9.69 x 23.43	310
Allambra I e II	486	18.90 x 25.71	670
El Pardo I e II	420	9.69 x 43.35	540



Underground

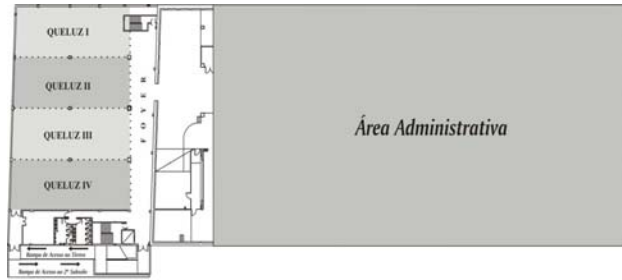

Ground Floor



1st Floor

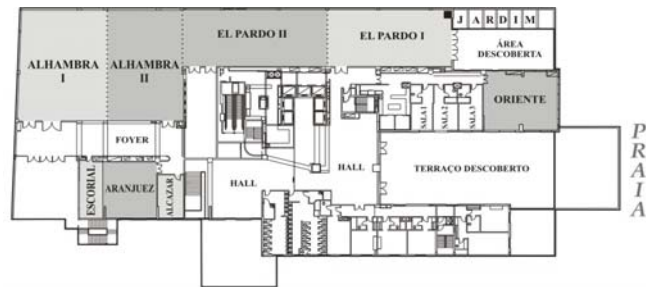

2nd Floor





Riocentro Convention Center



Riocentro is located in Barra da Tijuca, one of the most beautiful areas of the city, with several lagoons, mountains and 30 km of beaches. The Convention Center has direct access from both airports and from downtown Rio.

Five pavilions interconnected by 16-meter wide catwalks form Riocentro's complex. Pavilions 1 to 4 are designed to host fairs and exhibitions and Pavilion 5 (the Congress Hall) to host congresses and conventions. Facilities include a restaurant, medical aid, telecommunications, and parking space for 7,000 cars.

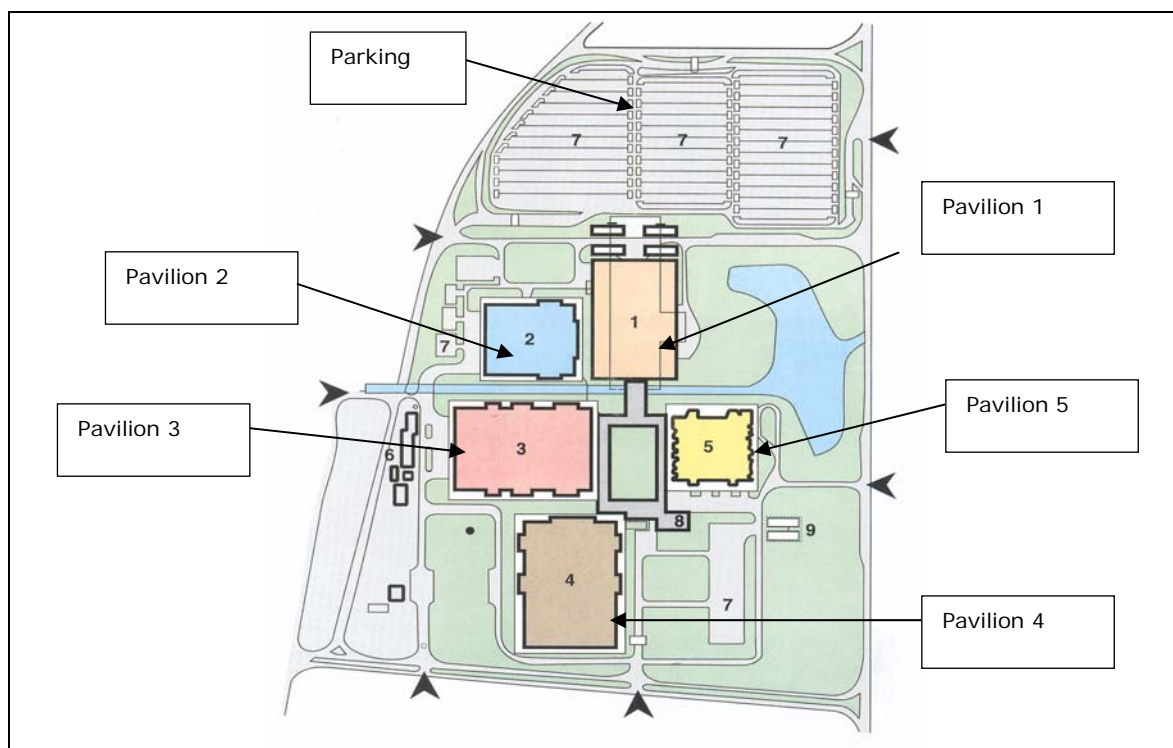

Pavilion 5

The Congress Hall (Pavilion 5) has a total area of 28,400 square meters, distributed on two floors. The ground floor has a large room, with removable dividing walls and movable seats, which receives up to 4,500 people sitting down in the format of an auditorium. The area further permits a banquet for up to 3,350 people or reception for 4,300 guests. Still on the ground floor, a modern VIP room with independent entrance, a press room, industrial kitchen, two dressing rooms, medical assistance and cargo and discharge area serve as support to the organizers. On the 2nd floor there are a hall of 1,000 square meters, 16 modular rooms for up to 700 people, bar, lobby and service areas destined to staff.

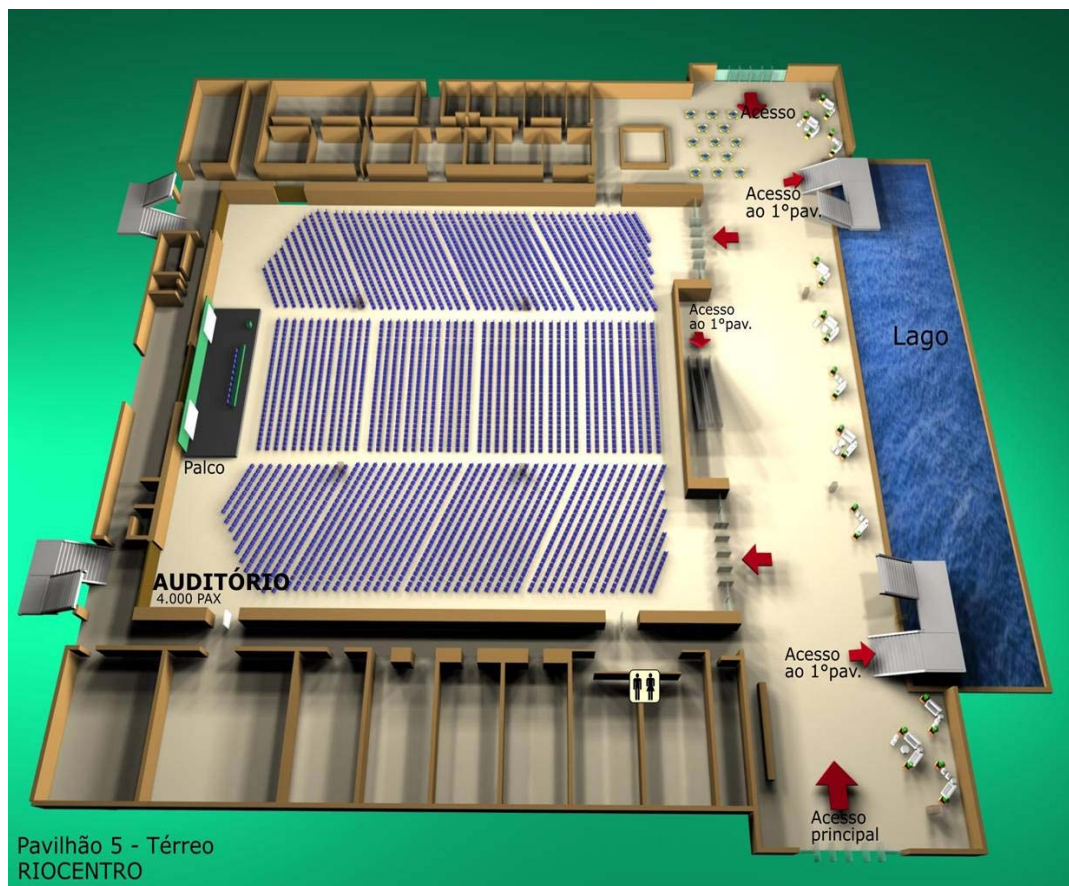

The upper floor accommodates 4 large rooms (695 square meters each, seating 600 people) and 8 medium sized rooms (ranging from 170 to 250 square meters each). In each of them, two removable acoustic walls allow for different room formats. A large circulation area is available for smaller exhibitions and other uses.

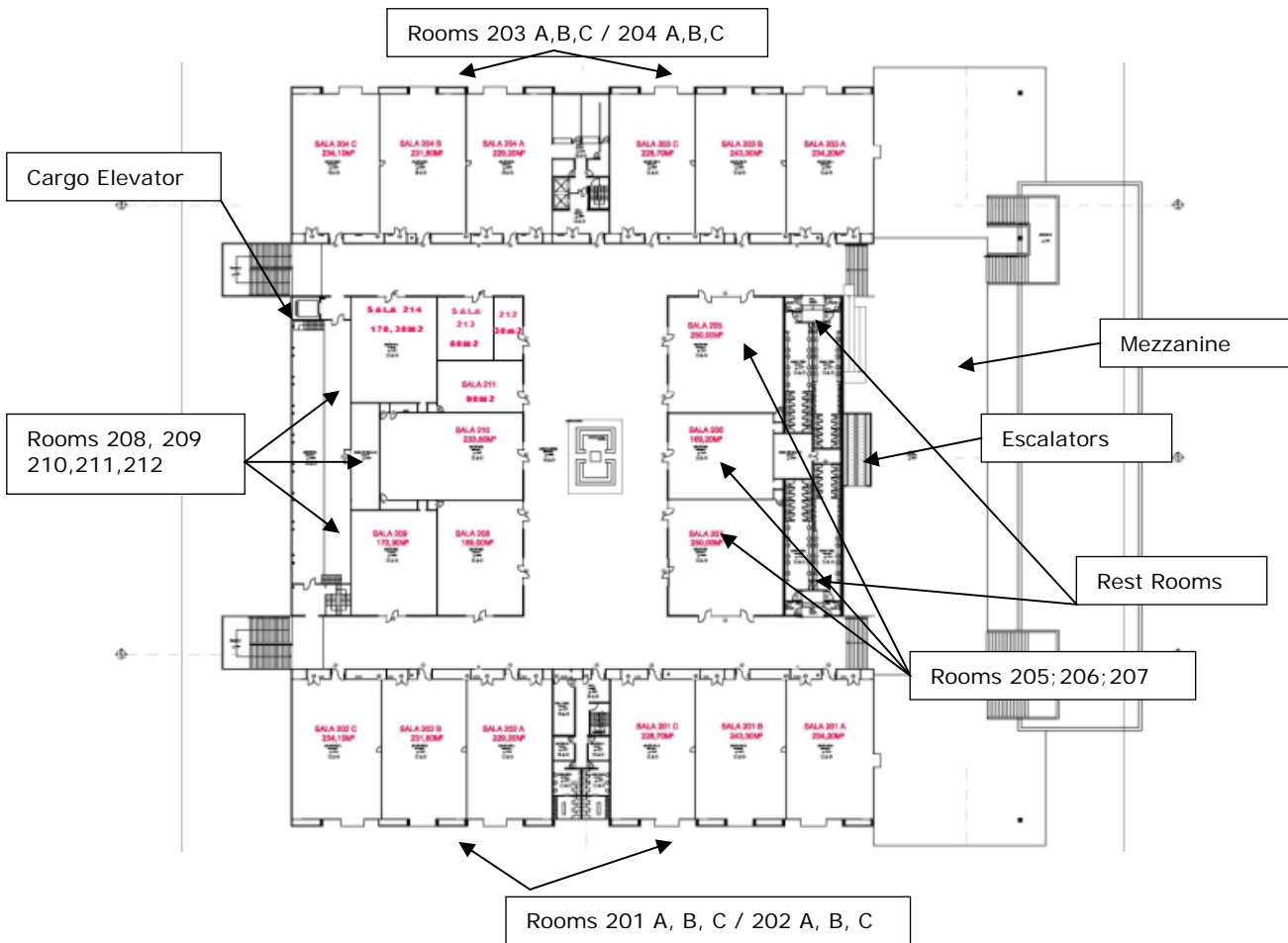





Accommodation



There is considerable variety of accommodation in Rio de Janeiro, from 5 star luxury hotels scattered near the shores of the city to good inexpensive hostels for backpackers and non-establishment travelers. The realization of the 2014 FIFA World Cup Finals in Brazil will further boost the city's lodging infrastructure, which already accommodates millions of visitors each year.

The South District beachside neighborhoods of Copacabana, Ipanema and Leblon have most accommodation options and represent a good base for visiting major attractions such as Sugar Loaf Mountain, statue of Christ the Redeemer that stands on top of Corcovado, Maracanã Stadium, Museums (Modern Arts, Fine Arts, Republic's, Carnival, etc) and several other places.

The category "Bed-and-Breakfast" in Brazil also offers daily rates at attractive residences with the most different styles, from classic to modern, according to categories that varies from Economic to Superior. More information can be obtained from the following websites:

<http://www.camaecafe.com.br/en/index.php>

<http://www.bbbrasil.info>

<http://www.riohomestay.com.br/>

Below is a partial list of accommodation locations, including price average for standard room, location and number of rooms.

SUPER LUXURY (From US\$ 600)		
	Number of Rooms	Neighborhood
Fasano Rio de Janeiro	92	Ipanema
Copacabana Palace	225	Copacabana
Sofitel Rio de Janeiro	388	Copacabana
Marriot Rio de Janeiro	245	Copacabana
Total	950	

LUXURY (From US\$ 400)		
	Number of Rooms	Neighborhood
Sheraton Barra	292	Barra
Windsor Barra Hotel	338	Barra
Pestana Rio Atlantica Hotel	216	Copacabana
Iberostar Copacana Hotel	496	Copacabana
Caesar Park Hotel	221	Ipanema
Sheraton Rio Hotel & Towers	559	Leblon
Hotel Intercontinental Rio	431	S.Conrado
Total	2553	

TOP CLASS (From US\$ 200)		
	Number of Rooms	Neighborhood
Transamérica Flat Barra	297	Barra
Royalty Barra	249	Barra
Paradiso All Suites	124	Barra
Tropical	102	Barra
Caesar Business Botafogo	110	Botafogo
Mercure Apartaments Botafogo	64	Botafogo
Windsor Guanabara Palace	531	Centro
Rio Othon Palace	585	Copacabana
Windsor Miramar Palace	156	Copacabana
Windsor Excelsior Copacabana	233	Copacabana
Porto Bay Rio International	117	Copacabana
Portinari	66	Copacabana
Princess Copacabana	77	Copacabana
Royal Rio	236	Copacabana
Mercure Queen Elizabeth	48	Copacabana
Mirasol Copacabana	95	Copacabana
Golden Tuplip Regente	236	Copacabana
Premier Copacabana	110	Copacabana
South American Copacabana	49	Copacabana
Mirador Rio	138	Copacabana
Orla Copacabana	115	Copacabana
Windsor Palace	74	Copacabana
Gloria	610	Gloria
Everest Rio	156	Ipanema
Ipanema Plaza	135	Ipanema
Mar Ipanema Hotel	77	Ipanema
Best Western Sol Ipanema	90	Ipanema
Mercure Apartaments Arpoador	56	Ipanema
Visconti (apart hotel)	48	Ipanema
Praia Ipanema	103	Ipanema
Marina All Suites	38	Leblon
Marina Palace	152	Leblon
Leme Othon Palace	190	Leme
Total	5467	

COMFORTABLE (From US\$ 80)		
	Number of Rooms	Neighborhood
Melia Confort Barra	216	Barra
Gaivota	41	Barra
Atlantico Sul	87	Barra
Entremares	64	Barra
Praia Linda	60	Barra
Sol da Barra	20	Barra
Real Hotel	33	Botafogo
Scorial Rio	57	Catete
Ibis - Largo São Francisco	200	Centro
Windsor Astúrias	166	Centro
Ibis- Santos Dumont	330	Centro
Formula 1	250	Centro
Ok	180	Centro
Royalty Copacabana	143	Copacabana
Vilamar	70	Copacabana
Copacabana Mar	96	Copacabana
Olinda Othon Classic	100	Copacabana
Tulip Inn Copacabana	112	Copacabana
Copacabana Hotel Residencia	70	Copacabana
Mar Palace	88	Copacabana
Windsor Martinique	117	Copacabana
Augusto's Copacabana	102	Copacabana
Atlantis Copacabana	87	Copacabana
Ibiza Copacabana	66	Copacabana
Real Palace	64	Copacabana
Copacabana Sol	70	Copacabana
Majestic Rio Palace	85	Copacabana
Dayrrell Ouro Verde	64	Copacabana
Best Western Rio Copa	109	Copacabana
Merlim Copacabana	145	Copacabana
Atlantico Copacabana	133	Copacabana
Astória Copacana	115	Copacabana
Acapulco Copacabana	122	Copacabana
Lancaster Hotel Travel	69	Copacabana
Copacabana Rio	94	Copacabana
Oceano Copacabana	90	Copacabana
Copa Sul	88	Copacabana
Rio Roiss	30	Copacabana
Benidorm Palace	83	Copacabana
Sesc Copacabana	120	Copacabana
Residencial Appart	24	Copacabana
Windsor Florida	224	Flamengo
Rondonia Palace	62	Flamengo
Novo Mundo	231	Gloria
Luxor Aeroporto	62	Ilha do Governador
Everest Park	25	Ipanema
Arpoador Inn	50	Ipanema
Ipanema Inn	56	Ipanema
Hotel Vermont	84	Ipanema
Golden Tulip Continental	275	Leme
Total	5329	

HOSTELS		
	Number of Beds	Neighborhood
Stone of a Beach	98	Copacabana
Che Lagarto	60	Copacabana
Rio Backpackers	45	Copacabana
Mellow Yellow	110	Copacabana
Copinha	50	Copacabana
Bamboo Rio	120	Copacabana
Copa	60	Copacabana
Rio Rockers	30	Copacabana
Copacabana Wave	43	Copacabana
Walk on the Beach	33	Copacabana
Copacabana Tropical	60	Copacabana
Brazuca's	24	Copacabana
Copacabana Beach House	52	Copacabana
King George	30	Copacabana
Newton's Roof Top	50	Copacabana
Adventure	36	Ipanema
Colinas	50	Ipanema
Piratas de Ipanema	48	Ipanema
Lighthouse	12	Ipanema
Ipanema Beach House	60	Ipanema
The Mango Three	40	Ipanema
Ipanema Wave	26	Ipanema
Casa 6 Ipanema	16	Ipanema
Harmonia	16	Ipanema
Terrasse	40	Ipanema
Crab Hostel Brasil	52	Ipanema
Lemon Spirit	52	Leblon
Ace Backpackers	70	Botafogo
Rio	25	Botafogo
Vila Carioca	60	Botafogo
Botafogo Easy	38	Botafogo
Green	60	Botafogo
Tupiniquim Hostel Rio de Janeiro	46	Botafogo
Alpha	60	Botafogo
El Misti	65	Botafogo
Sun Rio	35	Botafogo
Flamengo	23	Flamengo
Rio Hostel Santa Teresa	37	Santa Teresa
Trip	20	Santa Teresa
Santa Teresa	12	Santa Teresa
Best Hostel-Rio	15	Santa Teresa
Terra Brasilis	24	Santa Teresa
Brazil	50	Santa Teresa
Vila Casanova	10	Santa Teresa
Samba Villa	64	Santa Teresa
Rio Tijuca Hostel	47	Tijuca
Total	2074	





Transportation





Transportation to Rio

Rio's main port of entry is Tom Jobim International Airport, usually referred to by the older name *Galeão* Airport. Its two modern terminals can handle up to 15 million users a year. This airport complex has Brazil's longest runway (4,240 meters), and one of South America's largest and best equipped cargo logistics terminals.

The International Airport is located about 20 kilometers north of downtown Rio, on an island named *Ilha do Governador* (Governor's Island). The airport is connected to other areas of the city by two express highways: *Linha Vermelha* ("Red Line", leading into the downtown area and the South District) and *Linha Amarela* ("Yellow Line", leading into Barra and the West part of Rio). Bus and taxi services are available, as well as special Shuttle buses to (domestic) Santos Dumont Airport.

In addition to several international flights arriving to the Tom Jobim Airport, many flights reach Brazil through the international airports in the São Paulo area. There is plenty of flights connecting Rio to São Paulo (a 40 min trip), so this adds to the options for getting to the Congress venue.

Located in downtown Rio, right by the coastline, Santos Dumont Airport provides intense air shuttle service from/to São Paulo. After recent renovations, Santos Dumont's capacity is now estimated at 3.2 million passengers a year.

Travel time to Rio/São Paulo, from major cities around the world, is estimated as indicated:

Departure/Destination	Travel Time
Europe	11 to 12 hours
North America	9 to 14 hours
Central America	about 7 hours
South America	3 to 8 hours
Africa	about 10 hours
Middle East	about 15 hours
Far East	about 25 hours
Australia	about 18 hours

Tom Jobim's direct destinations include Asunción, Barcelona, Bogotá, Buenos Aires, Caracas, Copenhagen, Frankfurt, Houston, La Paz, Lima, Lisbon, London, Los Angeles, Luanda, Madrid, Mexico City, Miami, Montevideo, Nagoya, New York, Paris, Santa Cruz de La Sierra, Santiago de Chile, São Paulo, Tokyo, Washington, among other cities. Flight frequency to selected destinations are indicated in the next table.

Routes from/to Rio and São Paulo	Number of weekly flights
Rio – Atlanta	05
Rio – Chicago	07
Rio – Houston	07
Rio – Miami	27
Rio – New York	32
Rio – Frankfurt	07
Rio – Lisbon	50
Rio – London	20
Rio – Madrid	13
Rio – Milan	07
Rio – Paris	26
SP – Los Angeles	10
SP – Toronto	07
SP – Mexico City	07
SP – Amsterdam	07
SP – Munich	07
SP – Rome	06
SP – Zurich	07
SP – Tokyo	03
Rio – Buenos Aires	84
Rio – Caracas	21
Rio – Lima	16
Rio – Santiago	57
Rio -SP (GRU)	85
Rio-SP (CGH Air Shuttle)	Approx. every 20 minutes

Reflecting Rio de Janeiro’s increasing importance as a tourist location and venue for international meetings, the number of passengers choosing the Ton Jobim Airport as their gateway into Brazil has been growing steadily in the last years:

Year	Airplanes	Passengers
2003	68,806	4,619,229
2004	77,530	6,024,930
2005	97,332	8,657,139
2006	100,895	8,856,527
2007	119,892	10,532,616

Airlines flying to the International Airports of Rio de Janeiro or São Paulo include:

Aerolineas Argentinas	Aeroméxico	Aerosur
Air Canada	Air China	Air France
Air Minas	Air Portugal	Alitalia
American Airlines	Avianca	Bra
British Airways	Continental Air Lines	Copa Airlines
Delta Airlines	Emirates	Gol
Iberia	JAL	KLM
Lan Express	Lan-Chile	Lan Peru
Lufthansa	Ocean Air	Passaredo
Pluna	South African	Swiss Airlines
Taag Airlines	Taca Peru	TAM
TAP	United Airlines	Varig
Webjet		

Urban transportation System

Rio's public transportation system is inexpensive and effective: most places can be easily reached by metro, bus or taxi, or a combination of these.

Rio's subway system is in operation since 1979. It currently has 32 stations distributed along 36 kilometers and 2 lines (Linha 1, with 17 stations and Linha 2, with 16 stations), serving about half a million passengers a day. The system operates Monday to Saturday, from 5am to midnight, and Sundays and holidays from 7am to 11pm. The stations are safe, clean and well-lit, and the trains are modern, fast, and frequent.

Rio's subway authority also provides some bus lines that are integrated to the subway system; the map below displays such lines and their integration to the subway system.



In addition to the subway system and its extensions, 47 other private companies operate more than 1000 bus lines and services that crisscross Rio's many neighborhoods, providing access to virtually all corners of its metropolitan area.





Satellite Activities

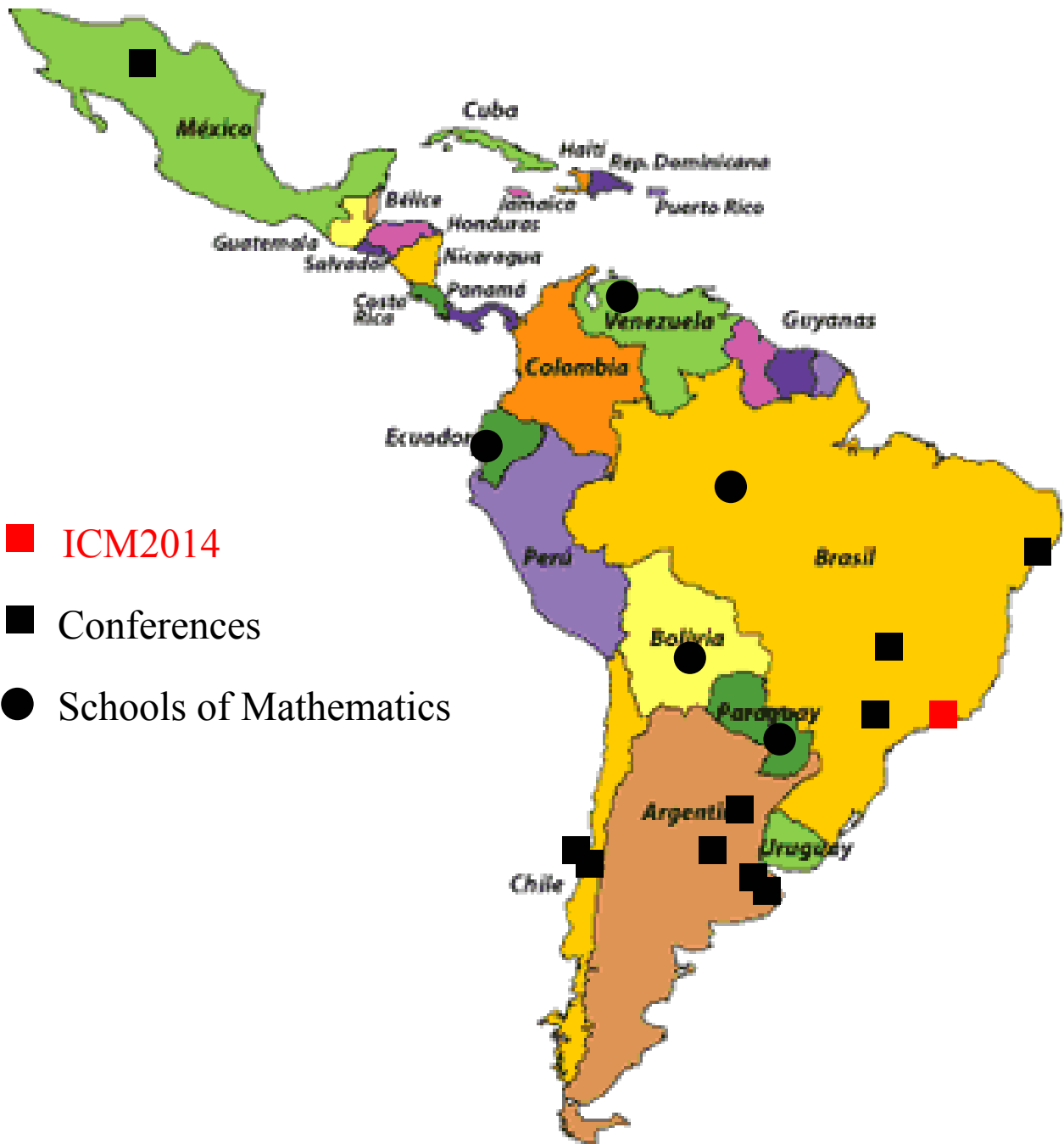



EMALCA Initiative

Schools of Mathematics across Latin America

As a satellite activity of the International Congress of Mathematicians ICM2014 in Rio de Janeiro, the Mathematical Union for Latin America and the Caribbean (UMALCA) proposes to organize a string of Schools of Mathematics in some of the mathematically least developed countries and regions in the continent, with ICM speakers as course lecturers. This will disseminate in a particularly effective way the impact of the ICM on Mathematics across Latin America.

The following proposals have been approved by UMALCA to be part of this initiative:

- **AMAZON 2014: Manaus, Brazil.**

Organizers: Cícero Mota (Brazil) and Leonardo Mora (Venezuela)

Target: students from the Amazon Basin.

- **PARAGUAY 2014: Asunción, Paraguay.**

Organizers: Christian Schaerer (Paraguay) and Roberto Markarian (Uruguay)

Target: students from central South America.

- **BOLIVIA 2014: La Paz, Bolivia.**

Organizers: Jimmy Santamaría (Bolivia & Brazil) and Abramo Hefez (Brazil)

Target: students from Bolivia, Southern Peru, and Northern Chile and Argentina.

- **VENEZUELA 2014: Mérida, Venezuela.**

Organizers: Carlos Di Prisco (Venezuela), Alfredo Iusem (Brazil)

Target: students from Venezuela, Colombia, Central America and the Caribbean.

- **ECUADOR 2014: Quito, Ecuador.**

Organizers: Marco Calahorrano (Ecuador) and Renato Benazic (Peru)

Target: students from Ecuador, Colombia, and Northern Peru.

UMALCA has been organizing Schools of Mathematics with a focus on the least developed countries and regions in Latin America since 2001. The following editions have been held to date: Mexico 2001, Venezuela 2002, Mexico 2003, Venezuela 2004, Bolivia 2004, Cuba 2004, Costa Rica 2005, Mexico 2005, Paraguay 2005, Venezuela 2006, Colombia 2006, Bolivia 2006, Nicaragua 2007, Mexico 2007, Paraguay 2007, Peru 2008, Venezuela 2008, Bolivia 2008.

The EMALCA Initiative is supported by the Centre International de Mathématiques Pures et Appliquées (CIMPA), the Brazilian Program for Scientific Cooperation in South America (PROSUL), the Committee for Development and Exchange (CDE) of the IMU, the International Center for Theoretical Physics (ICTP), and other regional and international institutions.

Roberto Markarian (Uruguay)
Coordinator of the EMALCA Committee

Satellite Conferences

The perspective of having the ICM2014 held in Rio de Janeiro launched a wave of enthusiasm across the region that materializes in several proposals for satellite meetings. The following proposals had been received by the date this file was closed:

Discrete Groups in Complex Geometry

Universidade Federal de Minas Gerais, Belo Horizonte, Brazil.

Organizers:

Nikolay Gusevskii (Universidade Federal de Minas Gerais, Brazil), Jose Seade (Universidad Nacional Autonoma de Mexico), Alberto Verjovsky (Universidad Nacional Autonoma de Mexico)

Partial list of speakers (tentative):

E. Ghys (ENS-Lyon, France), J. E. Fornæss (Michigan, USA), W. Goldman (Maryland, USA), M. Kapovich (Utah, USA), B. Klingler (Paris 7, France), B. Leeb (Tübingen, Germany), J. R. Parker (Durham, U. K.), D. Toledo (Utah, USA), R. Schwartz (Maryland, USA), D. Sullivan (Stony Brook, USA).

Complex Algebraic Geometry

Universidad de Buenos Aires, Argentina.

Organizers:

Carolina Araujo (IMPA, Brazil), Fernando Cukierman (Universidad de Buenos Aires, Argentina)

Partial list of speakers (tentative):

M. Brion (Grenoble, France), L. Carporaso (Rome, Italy), C. Faber (Baltimore, USA), B. Fantechi (Trieste, Italy), G. Farkas (Humboldt U., Germany), V. Ginzburg (Chicago, USA), S. Grushevsky (Princeton, USA), M. Kapranov (Yale, USA), S. Kebekus (Cologne, Germany), S. Kovács (Seattle, USA), A. Kresch (Zurich, Switzerland), J. M. Landsberg (Texas, USA), M. McQuillan (Glasgow, Scotland UK), M. Mustata (Michigan, USA), R. Pandharipande (Princeton, USA), J. V. Pereira (IMPA, Brazil), M. Popa (Chicago, USA), D. Oprea (UCSD, USA), J. Starr (Stony Brook, USA), I. Vainsencher (UFMG, Brazil)

Real and Complex Singularities

Universidade de São Paulo, São Carlos, Brazil.

Organizers:

Marcelo Saia (USP São Carlos, Brazil), Maria Aparecida Soares Ruas (USP São Carlos, Brazil), Jean-Paul Brasselet (Luminy, France)

Partial list of speakers (tentative):

L. Birbrair (UFC, Brazil), E. Esteves (IMPA, Brazil), S. Kleiman (MIT, USA), A. Dickenstein (Buenos Aires, Argentina), X. Gomez-Mont (CIMAT, Mexico), J. H. Bobadilla (Madrid, Spain), M. C. R. Fuster (Valencia, Spain), A. Libgober (Illinois, USA), W. Veys (Leuven, Belgium), V. Goryunov (Warwick, UK), I. S. Laboriau (Porto, Portugal), S. Janeczko (Polish Academy of Sciences), A. Pichon (Luminy, France), O. Saeki (Kyushu, Japan), G. Ishikawa (Sapporo, Japan), D. Siersma (Utrecht, Holland), W. Nuewmann (Columbia, USA).

Information and Randomness

Universidad de Chile, Santiago de Chile

Organizers:

Alejandro Maass, Servet Martinez, Jaime San Martin (CMM, Chile)

Partial list of speakers (tentative):

N. Berestycki (Cambridge, UK), A. Bovier (Berlin, Germany), X. Bressaud (Toulouse, France), Ch. Burdzy (Seattle, USA), J.-R. Chazottes (Paris, France), T. Downarowicz (Wroclaw, Poland), F. Durand (Picardie, France), R. Durrett (Cornell, USA), P. Ferrari (Buenos Aires, Argentina), J. Fill (Johns Hopkins, USA), L. R. Fontes (São Paulo, Brazil), A. Gnedin (Utrecht, Holland), M. Hochmann (Princeton, USA), Ch. Hoffman (Seattle, USA), B. Host (Marne-la-Vallée, France), W. Huang (U. Sci. Tech., China), B. Kra (Northwestern, USA), E. Lindenstrauss (Princeton, USA), H. Matzinger (Georgia Tech., USA), V. Maume (Lyon, France), S. Meleard (Polytechnique, France), Ph. Pollett (Queensland, Australia), Ph. Robert (INRIA, France), V. Sidoravicius (IMPA, Brazil), X. Ye (U. Sci. Tech., China).

Inverse Problems and Applications

CIMAT, Guanajuato, Mexico

Organizers:

Renato Iturriaga (CIMAT, Mexico), Miguel Angel Moreles (CIMAT, Mexico)

Partial list of speakers (tentative):

W. W. Symes (Rice, USA), G. Alessandrini (Trieste, Italy), M. Cheney (Rensselaer P. Institute, USA), J. Cheng (Fudan U., China), D. L. Colton (Delaware, USA), F. Santosa (Minnesota, USA), O. Scherzer, University of Innsbruck, Austria; G. Uhlmann, University of Washington, USA; A. Tarantola (Paris, France), H. T. Banks (North Carolina State, USA), H. Engl (Vienna, Austria), J. P. Kaipio (Kuopio, Finland), P. C. Sabatier (U. du Languedoc, France), M. Yamamoto (Tokyo, Japan), S. I. Kabanikhin (Sobolev Institute, Russia), G. Chavent (Le Chesnay, France), M. Burger (Münster, Germany).

Functional Analysis, Polynomials and Holomorphy

Universidade Federal da Paraíba, João Pessoa, Brazil

Organizers:

Daniel Pellegrino (Universidade Federal da Paraíba, Brazil), Geraldo Botelho (Universidade Federal de Uberlândia, Brazil)

Partial list of speakers (tentative):

M. Acosta (Granada, Spain), J. M. Ansemil (Madrid, Spain), R. Aron (Kent State, USA), O. Blasco (Valencia, Spain), C. Boyd (Dublin, Ireland), H.-A. Braunss (Potsdam, Germany), E. Çaliskan (Yıldız T. Ü., Turkey), D. Carando (Buenos Aires, Argentina), A. Defant (Oldenburg, Germany), V. Dimant. (San Andrés, Argentina), S. Dineen (Dublin, Ireland), V. Ferenczi (USP, Brazil), P. Galindo (Valencia, Spain), D. García (Valencia, Spain), J. Gutierrez (Madrid, Spain), H. Junek (Potsdam, Germany), M. L. Lourenço (USP, Brazil), M. Maestre (Valencia, Spain), M. C. Matos (Unicamp, Brazil), C. Michels (Oldenburg, Germany), L. A. de Moraes (UFRJ, Brazil), J. Mujica (Unicamp, Brazil), D. Pérez-García (Madrid, Spain), P. Rueda (Valencia, Spain), R. Ryan (Galway, Ireland), P. Sevilla-Peris (Valencia, Spain), D. Vieira (USP, Brazil), I. Zalduendo (Torcuato di Tella, Argentina).

Lie Theory and Geometry

Universidad Nacional de Córdoba, Argentina

Organizers:

Nicolás Andruskiewitsch, Laura Barberis, Leandro Cagliero, Jorge Lauret, Roberto Miatello, Juan Pablo Rossetti, Paulo Tirao, Cynthia Will (Universidad Nacional de Córdoba, Argentina)

Partial list of speakers (tentative):

M. Aguiar (Texas, USA), D. V. Alekseevsky (Edinburgh, UK), O. Baues (Karlsruhe, Germany), C. Benson (East Carolina, USA), J. Berndt (Univ. College Cork, Ireland), C. Böhm (Munster, Germany), R. Bruggeman (Utrecht, Netherlands), A. Cardona (Univ. de los Andes, Colombia), F. Catanese (Bayreuth, Germany), S. Console (Torino, Italy), V. Cortés (Hamburg, Germany), J. Cortissoz (Univ. de los Andes, Colombia), K. Dekimpe (Kortrijk, Belgium), I. Dotti (Córdoba, Argentina), M. Duflo (Paris 7, France), P. Eberlein (North Carolina, USA), P. Etingof (MIT, USA), E. Frenkel (Berkeley, USA), P. B. Gilkey (Oregon, USA), V. Ginzburg (California, USA), C. S. Gordon (Dartmouth College, USA), F. Grunewald (Düsseldorf, Germany), I. Heckenberger (Leipzig, Germany), L. Ji (Michigan, USA), V. Kac (MIT, USA), C. Kassel (Strasbourg, France), L. Lamóneda (CIMAT, Guanajuato, Mexico), Y. Laurent (Grenoble, France), C. Negreiros (UNICAMP, Brazil), G. Olafsson (Louisiana, USA), C. Olmos (Córdoba, Argentina), V. Ostrick (Oregon, USA), J. Petean Humen (CIMAT, Guanajuato, Mexico), G. Ratcliff (East Carolina, USA), L. San Martín (UNICAMP, Brazil), A. Masuoka (Tsukuba, Japan), P. Sarnak (Princeton, USA), H.-J. Schneider (Munich, Germany), B. Speh (Cornell, USA), J. A. Tirao (Córdoba, Argentina), J. Vargas (Córdoba, Argentina), D. Vogán (MIT, USA), N. Wallach (San Diego, USA), M. Wang (Canada), D. L. Webb (Dartmouth College, USA), B. Wilking (Munster, Germany), J. A. Wolf (Berkeley, USA), W. Ziller (Pennsylvania, USA).

Achievements and Challenges in Dynamics

Pontificia Universidad Católica de Valparaíso, Chile

Organizers:

Lorenzo J. Díaz (PUC-Rio, Brazil), Juan Rivera Letelier (PUC Santiago, Chile), Roberto Markarian (Universidad de la República, Uruguay), Carlos H. Vasquez (PUC Valparaíso, Chile)

Partial list of speakers (tentative):

J. Aaronson, J. Alves, V. Arnold, V. Baladi, P. Balint, E. Bedford, M. Benedicks, C. Bonatti, M. Boyle, M. Brin, A. Bufetov, L. Bunimovich, K. Burns, J. Buzzi, N. Chernov, A. Chéritat, P. Collet, G. Contreras, S. Crovisier, A. Delshams, M. Denker, N. Dobbs, D. Dolgopyat, T. Downarowicz, J. P. Eckmann, C. Favre, G. Forni, E. Ghys, S. Gorodetzky, J. Graczyk, S. Gouëzel, N. Gourmelon, P. Haissinsky, M. Hayashi, J. H. Hubbard, V. Y. Kaloshin, G. Keller, K. Khanin, Y. Kifer, F. Ledrappier, G. Levin, P. D. Liu, C. Liverani, R. de la Llave, S. Luzzatto, M. Lyubich, A. Katok, S. Katok, G. Keller, J. Marklof, C. T. McMullen, I. Melbourne, J. Milnor, M. Misiurewicz, Y. Pesin, M. Pollicott, F. Przytycki, C. Pugh, M. Rees, D. Ruelle, O. Sarig, S. Senti, W. Shen, M. Shishikura, M. Shub, N. Simanyi, Y. Sinai, J. Smillie, G. Świątek, D. Szasz, M. Todd, I. P. Toth, M. Tsujii, M. Urbanski, S. van Strien, A. Verjovsky, L. Wen, A. Wilkinson, M. Wojtkowski, J. C. Yoccoz, J. Yorke, L. S. Young, J. Xia, A. Zdunik.



Harmonic Analysis and Applications
Villa de Merlo, San Luis, Argentina

Organizers:

Hugo Aimar (Santa Fé), Carlos Cabrelli (Buenos Aires), Gustavo Corach (Buenos Aires), Eleonor Harboure (Santa Fé), Ursula Molter (U. de Buenos Aires), Pablo Panzone (U. del Sur), Marta Urciuolo (U. de Córdoba), Virginia Vera de Serio (Mendoza), Felipe Zó (San Luis).

Partial list of speakers, (tentative):

A. Aldroubi (Vanderbilt, USA) J. Benedetto (Maryland, USA), O. Blasco (Valencia, Spain), J. Bruna (Barcelona, Spain), L. Caffarelli (Austin, USA), G. Corach (Buenos Aires, Argentina), S. Jaffard (Paris VII, France), E. Harboure (Santa Fe, Argentina), M. Lacey (Georgiatech, USA), S. Mallat (Ecole Polytechnique, France), M. A. Muschietti (La Plata, Argentina), S. Ombrosi (Bahia Blanca, Argentina), K. Osdjuko (Maryland, USA), C. Perez (Sevilla, Spain), A. Powell (Vanderbilt, USA) J. L. Torrea (Madrid, Spain), B. Torressani (Marseille, France).

Foundations of Computational Mathematics
Universidad de Buenos Aires, Argentina

Organizers: Teresa Krick (Argentina) on behalf of the Board of Directors of FoCM

Speakers at 2008 edition (Hong-Kong): F. Brezzi (Pavia), P. Bürgisser (U. Paderborn), E. Candes (Caltech), P. Deift (New York University), L. Devroye (Carleton U.), A Dickenstein (Buenos Aires), N. Dyn (Tel Aviv), P. Flajolet (INRIA), R. Gaston Gonnet (ETH Zürich), A. Its (Indiana), P. Kloeden (Frankfurt), H. Lenstra (Leiden), P. Parrilo (MIT), C. Schwab (ETH Zürich), C. Simó (Barcelona), E. Tadmor (Maryland), R. Wong (Hong Kong), H. Wozniakowski (Columbia and Warsaw).







General Assembly





We invite the IMU General Assembly to the Costa Verde (Green Coast), one of the most beautiful stretches of Brazilian coastline. Starting just south of Rio de Janeiro and running for some 270 Km, Costa Verde displays a unique mixture of jungle covered mountains, untouched tropical forest, limpid lagoons, waterfalls and beaches, and over 300 pristine ocean islands, accessible by boat from the continent. Most of Costa Verde, including stunning Ilha Grande (Big Island), is protected under Atlantic Forest Reservation.



The towns of Angra dos Reis and Mangaratiba offer several resorts and hotels with excellent convention center infrastructure to host the 2014 General Assembly of the IMU.

Eco Resort de Angra dos Reis

Located in Angra dos Reis, Eco Resort offers a fully equipped convention center that can host up to 1,600 people.





Club Med Village Rio das Pedras

Located in Mangaratiba, Club Med Village Rio das Pedras offers a fully equipped convention center that can host up to 600 people.





Tourism and Culture

Brief History of Rio de Janeiro

Before the arrival of Europeans, the area of present-day Rio de Janeiro was inhabited by indigenous people, who subsisted on hunting, fishing, gathering and semi-nomadic agriculture. The first Portuguese expedition to the area arrived at Guanabara Bay in January 1502. At the time the bay was named *Rio de Janeiro* (or “January River”). Although formally under Portuguese rule, the area soon became a port for French smugglers interested in brazilwood. As part of a counteroffensive to drive the French out, the Portuguese founded the village of *São Sebastião do Rio de Janeiro* in 1565.

By the 17th century Rio had become the third most important Portuguese settlement in the continent, after Salvador and Recife/Olinda in the Northeast. Sugar plantations were the basis of the local economy. In the 18th century gold, silver and precious stones were first discovered in the Minas Gerais region. As the nearest port to Minas, Rio benefited immensely from increased trade, rose in status, and eventually became the colonial capital.

In the beginning of the 19th century, Napoleon threatened Portugal with invasion by French troops, forcing the Portuguese royal family and court to seek sanctuary in Rio. With their arrival in 1808, Rio became the capital of the United Kingdom of Portugal, Brazil and Algarve. Important events from the time include the opening of Rio’s Botanical Garden, the reforestation of what is now Tijuca Forest, and the founding of the first local university. Brazil became an independent empire in 1822 and Rio became the capital of the new country, a privilege it retained after Brazil became a republic in 1889.

In the first half of the 20th century, Rio prospered as Brazil’s political and cultural capital and became a favorite destination for Hollywood stars and the international jet set. In the 1960’s Brasília became the political capital of Brazil. Starting in 1964, a 25-year military dictatorship hindered Brazil politically, socially and economically. Nonetheless, those were thriving times for the arts in Rio, with new artistic movements and a renewed interest in *samba*, *choro* and other traditional musical styles.

The 1990’s and the early 21st century have been a time of material progress. Brazil’s economy has recovered from several years of hyperinflation and local businesses are again on the rise. Important investments in infrastructure were made and large international events were recently (or will soon be) hosted in Rio, such as the 1992 UN environmental summit (Eco 92); the 2007 Pan American Games; and the upcoming 2014 FIFA World Cup Finals. The local music scene is as vibrant as ever, and the same is true for cinema and the fine arts. Tourism has grown over the last 18 years and Rio is again a top destination for leisure and business travel. Some problems from the past remain to be solved, but things again look bright and promising for the *Cidade Maravilhosa* (Wonderful City).

Orientation

Rio de Janeiro lies on a 20 km wide strip of alluvial land between the Guanabara and Sepetiba bays. The local landscape is a unique blend of nature, beaches, mountains, and heavily urbanized areas.

The downtown business district on Guanabara Bay, known as *Centro*, and the adjacent neighborhoods (*Lapa*, *Santa Teresa*, *Saúde*) are the oldest part of the city. The many historical buildings, churches and museums in the area coexist with high-rise office buildings.



Zona Sul and *Zona Norte* – the South and North Districts – are defined by their positions relative to *Centro*. Scenic *Zona Sul* is squeezed between the Tijuca hills/forest and the sea. Many visitors to Rio spend most of their time in the area, at the local beaches, shops, bars, restaurants and night clubs.



Zona Norte lies on the other side of the Tijuca hills. The area is mostly residential, but houses attractions such as the Maracanã stadium, Quinta da Boa Vista and many bars, restaurants and samba schools.



Zona Oeste (West District) lies west of the Tijuca hills and comprises the rest of the city. Much of *Zona Oeste* was virtually undeveloped 30 years ago and there are still semi-rural stretches around the Pedra Branca state park. The beaches at Barra da Tijuca, Recreio, Prainha and Grumari are *Zona Oeste*'s main tourist attractions, but the area's large shopping malls and busy night clubs are also quite popular.



Most of Rio is well connected by an inexpensive public bus system: most tourism and business areas are connected by a single bus ride. The Metro underground/bus system offers faster rides in *Zona Norte*, *Zona Sul*, and part of Barra da Tijuca. Taxi cabs are a cost effective alternative for most trips within the *Zona Sul* and *Centro*.

Culture

Popular music

Popular music has been a key part of Brazil's cultural identity since colonial times, when *modinhas* and *lundus* made their way to the Portuguese court in Lisbon. Today, Rio's music scene is one of the best and most distinctive in the world.

Samba is an Afro-Brazilian genre that was born in Bahia and found its definitive form in early 20th century Rio. *Choro* or *chorinho* is a related, mostly non-vocal genre that is heavy on improvisation, originated in the late 19th century, blending African and European influences. Both styles can be found in all kinds of venues, ranging from concert halls to night clubs and more informal gatherings at bars or squares (known as *rodas de samba* and *rodas de choro*).

Lapa and the rest of downtown offer some of the best venues for samba and choro in Rio, ranging from clubs for the quiet appreciation of music (*Rio Scenarium*) to ballrooms such as *Estudantina* and *Elite* and busier venues that are favorites with the young (*Clube dos Democráticos*). In Zona Sul, Laranjeiras and Santa Teresa host high-quality open-air *rodas de samba* and *rodas de choro* that meet on a regular basis.

Most of *samba schools* that take part in the Carnival parades are located in Zona Norte. The most traditional schools retain their original character of neighborhood associations of *sambistas* and have musical luncheons (*feijoadas*) on weekends. The schools also have busy *open rehearsals* to prepare for Carnival.



Baião, xote, côco and other rhythms collectively known as *forró* have been brought to Rio by migrants from the Brazilian Northeast and have become quite trendy in recent years. One can dance to *forró* at *Centro de Tradições Nordestinas* in São Cristóvão, and also at Lapa and Santa Teresa.

Bossa nova and the related styles of *samba jazz* and *música popular brasileira (MPB)*, all born in Rio between the 1950's and 1970's, are not as in vogue as samba or choro, but can also be heard at local concert halls and night clubs throughout Rio.

Orchestral and chamber music

Rio is home to two of Brazil's best orchestras: the Orquestra Sinfônica Brasileira and the Orquestra Petrobrás Pró-Música. These and other orchestras have their major concerts in *Theatro Municipal* downtown. *Sala Cecília Meirelles* in Lapa and *Candelária Church* are two of the best local venues for chamber music.

Cidade da Música -- a new, world-class concert hall in Barra da Tijuca -- is expected to be completed by early 2009.



Film

The city is also an important center for Brazil's movie industry, as many movies are filmed and/or produced here. It also has a devoted public of moviegoers and there are many movie theaters in the city. *Festival do Rio*, the city's main film festival, is the largest of its kind in Latin America.

Miscellaneous

Many theater and dance companies either reside in or frequently visit Rio. The city has also been the home of many of Brazil's best writers, including Machado de Assis, Carlos Drummond de Andrade and Manoel Bandeira.

Cuisine

As a large, cosmopolitan city, Rio offers dining options from around the world, especially from nationalities that have contributed strongly to the Brazilian melting pot such as German, Italian, Japanese and Lebanese.

However, the most noticeable influences on the local cooking style are Portuguese. The most traditional restaurants in Centro serve fresh fish and seafood with appetizing side dishes. Most bars in the city offer fried and/or cooked savory pastries called *salgadinhos*.



At *churrascarias* the main attractions are grilled red meat stakes marinated in salt (no sauces!) served with *farofa* (fried manioc flour), *batata frita* (French fries) and other side dishes. *Churrascarias rodízio* are a more recent invention and feature all-you-can-eat Pampas-style barbecue and big buffets.

Feijoada – a black bean stew invented by African slaves – is as close to being Brazil's national dish as any other; many restaurants serve it for lunch on weekends. Lighter eating options include the *juice stores* near the beaches in Rio, which offer tropical fruit juices and smoothies (including *açaí*), sandwiches and salads.



Historical Neighborhoods

Lapa and **Santa Teresa** are two of Rio's oldest and most distinctive neighborhoods. Santa Teresa lies on the hills that separate Centro and Zona Norte on one side from Zona Sul on the other side. This leafy, labyrinthine district with cobbled streets, well-preserved 19th century architecture and beautiful vistas of Centro is one of Rio's most visually appealing neighborhoods. It is also a haven for artists and there are many ateliers, exhibits and informal musical gatherings in the area, as well as great bars and restaurants.



A picturesque tram car ride takes one from Santa Teresa to Arcos da Lapa, an old Roman-style aqueduct that dominates the landscape of Lapa. One may also find 19th century and early 20th century architecture in Lapa, especially at *Praça da Cruz Vermelha* and in the charming *Passeio Público* park. At night, the area does justice to its Bohemian reputation with its many music venues and traditional bars and restaurants.





Beaches and beach neighborhoods

Copacabana and Leme

These are adjacent neighborhoods that correspond to different stretches of a single beach. *Leme* is relatively quiet, whereas *Copacabana* is a densely populated neighborhood with lots of cost-effective options for accommodation, dining and shopping. The two beaches are connected by a single bike path and a sidewalk (*calçadão*) with many bars and open-air restaurants.



Ipanema and Leblon

West of Copacabana and connected to it by a bike path and *calçadão* lie Ipanema and Leblon. These are Rio's most stylish neighborhoods and some of the city's best shopping and leisure options are located in the area. Fortunately, the region has retained much of the down-to-earth charm that is characteristic of Rio. There are many good hotels and hostels in the area.





Barra da Tijuca and Recreio dos Bandeirantes

These are long beaches in Zona Oeste that are favored by many locals, as well as tourists who choose to stay in the area. The corresponding neighborhoods feature large shopping malls, restaurants and nightclubs.



Prainha

West of Recreio lies Prainha, a small, undeveloped beach within a rainforest-covered state park. Many visitors to the area choose to have lunch at the excellent seafood restaurants in nearby Guaratiba.



Major Tourist Sights

Corcovado/Cristo Redentor (Christ the Redeemer)

The Corcovado hill (alt. 710 m) within the Tijuca Park offers a sweeping panoramic view of Rio. The 38-meter-tall Cristo Redentor statue is located on the hilltop.



Pão de Açúcar (Sugar Loaf)

This round-shaped hill (alt. 396 m) lies at the mouth of Guanabara Bay. A two-stage cable-car trip takes visitors to the top of the hill, which has a pleasing view of Rio, the Bay and the ocean.



Estádio Jornalista Mário Filho (Maracanã Stadium)

Inaugurated in 1950, Maracanã has achieved legendary status as Brazil's foremost football stadium. Its Hall of Fame features memorabilia related to past and present footballers.





Teatro Municipal (Municipal Theater)

Inaugurated in 1909, it remains one of the city's most notable buildings, as well as Rio's main venue for large orchestras and opera companies.



Real Gabinete Português de Leitura (Royal Portuguese Reading Room)

This library in neo-manueline (Portuguese renaissance) style was inaugurated in 1887 to celebrate the historical and cultural ties between Brazil and Portugal.



Igreja de Nossa Senhora da Glória do Outeiro (Church of Our Lady of Glory at Outeiro)

Atop Outeiro hill, this is Rio's most charming church in the Portuguese colonial style.

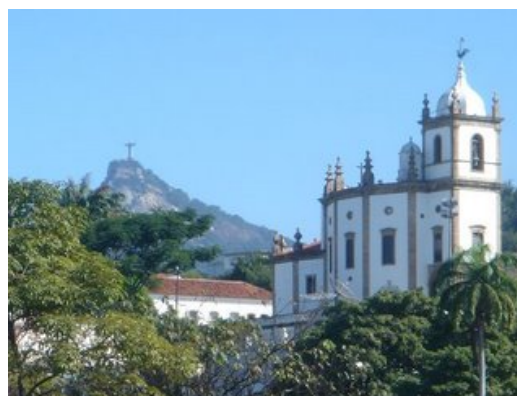



Igreja da Candelária (Candelária Church)

This massive church in Centro is Rio's most important architectural work from the 19th century.



Catedral do Rio de Janeiro (Cathedral of Rio de Janeiro)

This is an unconventional cone-shaped church in Lapa.



Igreja de São Bento (Saint Benedict's Church)

This ornate baroque church belongs to a Benedictine monastery founded in 1586 in downtown Rio. The monastery's choir performs Gregorian chant during Sunday mass.



Forests and parks

Parque da Floresta da Tijuca (Tijuca Forest Park)

Founded by the Portuguese Prince Regent Dom João VI in the early 19th century, the Tijuca park is a lush, massive tropical rainforest that covers most of the Tijuca hill system and offers excellent hiking, climbing and animal watching opportunities. The park dominates the landscape in much of Zona Sul, Zona Norte and Barra da Tijuca. It also offers breathtaking vistas of Rio.



Lagoa Rodrigo de Freitas (Rodrigo de Freitas Lagoon)

Lagoa lies at the heart of Zona Sul, within walking distance from Ipanema and Leblon. It is surrounded by a sidewalk, bike and jogging paths, sports courts, and bars and restaurants near the lagoon waters. The surrounding hills add to the area's beautiful landscape.





Jardim Botânico (Botanical Garden)

Also founded by Dom João VI, its attractions include a large collection of rainforest bromeliads, giant palm trees from Central America. Rio's Environmental Museum is adjacent to the garden.



Quinta da Boa Vista

These are the grounds of the former summer palace of the imperial family.



Aterro do Flamengo

This park by Guanabara bay has a beautiful view of the Sugar Loaf. Attractions include a long and pleasant bike path, sports courts, and a mausoleum for Brazilian World War II soldiers.



Museums

Museu Nacional de Belas Artes (National Fine Arts Museum)

Housed in a large Neoclassical building in Centro, the museum's collection documents the various stages of Brazilian art from its early beginnings to the 20th century.



Museu de Arte Contemporânea (Museum for Contemporary Art)

Across Guanabara Bay lies Niterói's Museum of Contemporary Art. Its flying-saucer-shaped building sits on a cliff over Guanabara Bay and is an attraction in itself.





Museu Histórico Nacional (National Historical Museum)

This museum tracks the history of Brazil from the arrival of the Portuguese to the Brazilian republic. Temporary exhibits have ranged from the Dead Sea Scrolls to Charles Darwin.



Museu da República (Museum of the Republic)

This is a museum devoted to the history of republican Brazil up to the 1960's, when Brasília became the capital of the country.



Attractions near Rio

Petrópolis and Teresópolis

Petrópolis was Brazilian emperor Dom Pedro II.'s summer retreat. His former palace is now *Museu Imperial*. Teresópolis is known for the beautiful *Serra dos Órgãos national park*.



Região dos Lagos (Lakes Region)

This is the stretch of coast immediately to the northeast of Rio and Niterói. The most interesting town in the region is *Búzios*, with varied beaches and bustling nightlife.



Costa Verde (Green Coast)

The Green Coast is southwest of the city and has white-sand beaches squeezed between rainforest-covered hills and the sea. Attractions include the colonial town of *Paraty*; the beaches in *Angra dos Reis*, *Ilha Grande* (Big Island) off the coast, with excellent hiking and many undeveloped beaches.

